

Panasonic®

Operating Instructions

使用說明書

(Household) Hair Dryer

(家用) 吹風機

Model No. EH-ND21
型號

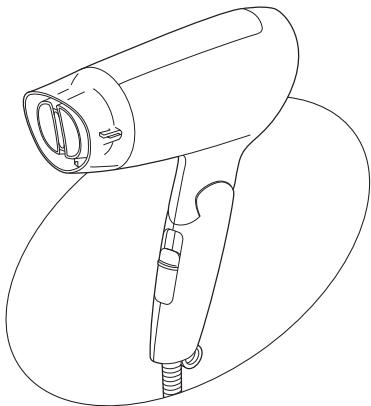

| | |
|---------|---|
| English | 2 |
| 中文 | 7 |

Before operating this unit, please read these instructions completely and save them for future use.

使用本產品前，請仔細閱讀此說明書，並妥善保存以備未來使用。

Thank you for choosing a Panasonic hair dryer. Please read all instructions before use.

Parts identification

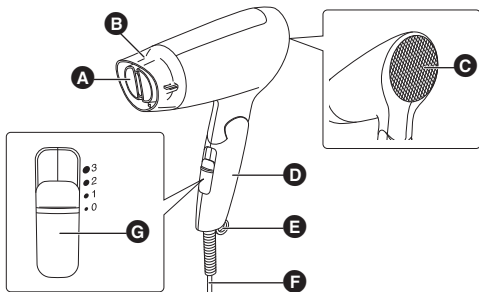

A Air outlet

B Quick-dry nozzle

C Air inlet

D Handle

E Ring for hanging

F Cord

G Main Switch

3: Dry (Strong airflow)

2: Set (Gentle airflow)

1: Cool (Cool airflow)

0: Off

Caution

- Keep your hands away from the air outlet as it may cause burns.
- If the air inlet is damaged, stop using the hair dryer immediately. Using it may result in burns.
- Only use the hair dryer for the intended purposes. Do not use it for infants.
- If the hair dryer is damaged, stop using it.
- Avoid touching the attachments as they become hot during and after use.
- Make sure hair does not get sucked into the air inlets.
- Be careful about where you point the hair dryer, and be sure to keep your hair at least 10 cm away from the air inlet. Failure to do so may result in your hair becoming sucked in and trapped in the hair dryer.

- Please keep a distance of over 3 cm between the air outlet and your hair. Failure to do so may result in your hair being burned.
- Avoid using thinner, benzine, or any other solvent to clean the hair dryer.
- This hair dryer is equipped with an automatic overheating protective device. If the hair dryer overheats, it will switch to cool airflow mode. Switch off the hair dryer and unplug it from the power socket. Allow it to cool down for a few minutes before using it again. Check that no fluff, hair etc. is in the air inlets and outlets before switching it on again.

Important

Please read the safety instructions before using this hair dryer. The safety instructions explained here help you to use this hair dryer safely and correctly, and also to prevent you from injuring yourself or others.

WARNING: Not following the instructions below may cause fire, burns, explosion, short circuiting or electric shock.

● Electrical Conditions



WARNING: This symbol with prohibition sign in red on the appliance means “Do not use this appliance near water”. Do not use this hair dryer near bathtub, showers, basins or other vessels containing water.

- Always switch off the hair dryer (“0” position) after use and before unplugging it from the power socket. Unplug it from the power socket when not in use. Always grasp the plug while unplugging. Failure to do so may lead to fire and/or an accident.
- Before connecting the hair dryer, check that the voltage of the hair dryer corresponds to the local voltage.

- Avoid cutting, damaging, or modifying the cord. Avoid pulling, twisting, or bending the cord with unnecessary force. Avoid placing heavy objects on the cord or allow it to get pinched in between objects. Wrapping the cord around the hair dryer may cause fire and/or electric shock. If the cord is damaged or becomes hot, stop using it immediately.

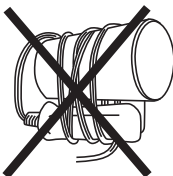

- When the hair dryer is used in a bathroom, unplug it after use since the proximity of water presents a hazard even when the hair dryer is switched off.
- For additional protection, the installation of a residual current device (RCD) having a rated residual operating current not exceeding 30 mA is advisable in the electrical circuit supplying the bathroom. Ask your installer for advice.

● Using the hair dryer

- Stop using it immediately if the hair dryer does not produce air constantly and the cord or plug is damaged or becomes hot; or the plug fits loosely in the outlet.
- Never insert foreign objects into or otherwise block either the air inlet or outlet.
- Avoid using the hair dryer near inflammable materials such as benzene, paint thinner, spray, etc.
- Only use the appliance when the hands are dry.
- Use and place the hair dryer only in a dry location. Never submerge the hair dryer in water.
- This appliance is not intended for use by persons (including children) with reduced physical, sensory or mental capabilities, or lack of experience and knowledge, unless they have been given supervision or instruction concerning use of the appliance by a person responsible for their safety.
Children should be supervised to ensure that they do not play with the appliance.

How to use the hair dryer

Select the intensity of the airflow with the main switch.

● Notes

- If you want to dry your hair quickly, set the quick-dry nozzle in the direction shown in the illustration.

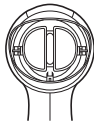

Repair and maintenance of the hair dryer

- Only qualified personnel should repair or disassemble the hair dryer.
- If the cord is damaged, it must be replaced by the manufacturer, its service agent, or similarly qualified persons in order to avoid a hazard.
- If the cord or plug is damaged, stop using it immediately and contact an authorized Panasonic service center.
- When the hair dryer is blowing hot air, occasionally air may turn cool or sparks may be seen. In such cases, dust may have accumulated at the air inlet and/or the air outlet. Also, the air inlet may be being blocked by your hair, hands, etc. (This phenomenon is the result of the hair dryer's thermal switch. The sparks do not pose a danger in and/or themselves.) Slide the main switch to the "0" position and remove any dust that has accumulated.

● Maintenance of air outlet and air inlet (once a month or more)

- To clean the air outlet, set the main switch to "1", and rake out with a brush while cool air is blowing out.
- To clean the air inlet, set the main switch to "0" and, with the airflow stopped, remove dust and hairs using a brush or vacuum cleaner.

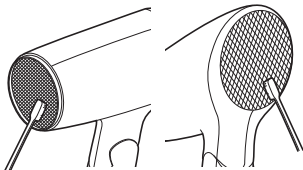

- Be careful since dust may spray out.
- When dust clogs the mesh, the thermostat switch will operate, frequently switching to cool airflow and reducing the drying/set performance.

- The thermostat switch is a protective device. Sparks may be seen during operation but these do not present any danger.

Specifications

Model No.: EH-ND21

| | |
|-------------------|------------------|
| Voltage | 110 V 60 Hz |
| Power consumption | 1200 W |
| Accessory | Quick-dry nozzle |

This product is intended for household use only.

CAUTION!

Failure to follow these safeguards could result in injury to fingers.

When extending the handle

DO NOT TOUCH the shaded area in the diagram below when holding the handle or using the hair dryer.

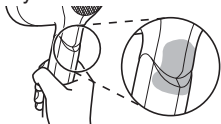

When folding the handle

DO NOT TOUCH the shaded area in the diagram below when folding the handle.



部件說明

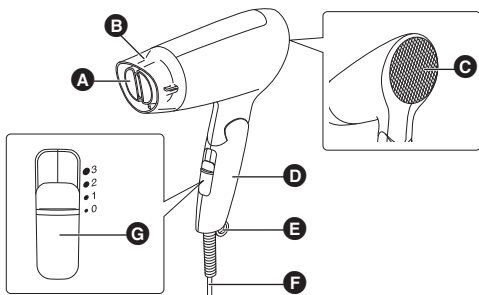

- A** 出風口
- B** 速乾護髮吹嘴
- C** 入風口
- D** 把手
- E** 掛環
- F** 電源線

- G** 電源開關
 - 3: 強風
 - 2: 柔風
 - 1: 冷風
 - 0: 關

注意

- 請勿將手放在出風口上。否則可能被燙傷。
- 若入風口受損，請勿使用本產品。否則可能被燙傷。
- 吹風機除吹頭髮外，請勿用作其他用途。且勿讓幼兒及兒童使用吹風機。
- 請勿使用已損壞的吹風機。
- 請勿觸摸附件，因為使用時或使用後附件會變熱。
- 注意不要讓頭髮吸入入風口。
- 小心注意自己手持吹風機的方向，並確保您的頭髮與入風口保持最少 10cm 的距離。否則可導致吹風機吸入並纏繞您的頭髮。
- 請將您的頭髮與出風口保持超過 3cm 的距離，否則可令您的頭髮被燒焦。
- 請勿使用稀釋劑、汽油或任何其他溶劑來清潔吹風機。
- 此吹風機配有一個自動過熱保護裝置。如果吹風機過熱，吹風機將轉換到冷風模式。關閉吹風機並將插頭拔出電源插座。等吹風機冷卻數分鐘後再使用。再次通電前確認吹風機的入風口和出風口的裏面沒有絨毛、頭髮等物。

安全指示

使用吹風機前請閱讀安全指示。這裏說明的安全指示將幫助您正確安全地使用吹風機，以避免傷害到自身或他人。

警告：不遵守以下指示會造成火災、灼傷、爆炸、短路或電擊。

● 電氣狀況



警告：此設備上帶有禁止紅色標誌的符號表示“請勿在靠近水的地方使用本產品”。

- 使用後在將插頭拔出電源插座前務必關閉吹風機（“0”位置）。不使用時將吹風機的插頭拔出電源插座。拔插頭時請務必抓住插頭，否則可能會造成火災和意外。
- 接通吹風機前，檢查吹風機的使用電壓是否符合當地電壓。
- 請勿切斷、損壞或改裝電源線。請勿過分用力拉扯、扭曲或彎曲電源線。請勿將重物放置在電源線上，或被物體夾住。請勿將電源線捲繞在吹風機上，因為這會造成火災和電擊。若是電源線損壞或發熱，立即停止使用。

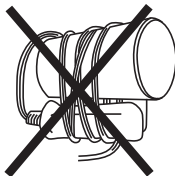

- 若在浴室中使用吹風機，使用完畢後請拔下電源插頭，因為即使吹風機已經關掉，它在接近水時仍然存在危險。
- 為了更好地保護您的安全，建議您在浴室的供電電路中安裝一個額定漏電動作電流不超過 30mA 的漏電保護開關（RCD）。請向安裝者諮詢意見。
- 禁止使用延長線。

● 使用吹風機時的安全指示

- 若是吹風機不能持續吹風而且電源線和插頭已損壞或發熱；或者插座的插頭變鬆，請立即停止使用吹風機。
- 請勿將異物插入或堵塞入風口或出風口。
- 請勿靠近易燃物品如汽油、油漆稀釋劑和噴霧劑等使用吹風機。
- 手濕時請勿使用吹風機。
- 請勿在濕度高的地方使用或放置吹風機。請勿將吹風機浸入水中。

- 患有體能、感官或智力減退，或缺乏經歷和知識之人士（含小孩），在無人監護或未獲告知如何使用的情况下不得使用本產品。
請勿讓小孩使用本產品。

緊急處理方法

- 發生異常時（有燒焦味等）須立即停止運轉並拔掉電源插頭。
- 若在異常狀態下繼續運轉，會因發熱等情形，造成火災及觸電的發生。
 - 請速與 Panasonic 授權服務中心或經銷商洽詢。
 - 電源線損壞時，需由 Panasonic 授權服務中心人員更換以避免危險。

使用吹風機的方法

使用電源開關選擇風力強度。

● 注意事項

- 若您想將頭髮迅速吹乾，請如圖所示方向調整速乾護髮吹嘴。



吹風機的保養和維護

- Panasonic 維修中心可以修理或拆卸該吹風機。
- 如果本機的電源線已經損壞，務必立即停止使用，並送交 Panasonic 維修中心進行更換。
- 如果電源線或插頭損壞，立即停止使用吹風機並聯絡全省的 Panasonic 維修中心。
- 當吹風機吹熱風時，若吹風經常變冷，並且有時能看到火花，這表示在入風口或出風口堆積了灰塵，或者您的頭髮或手正擋住入風口。（該現象是吹風機的熱控開關作用的結果。火花不會造成危險或其本身也無危險。）將電源開關按至“0”的位置，然後清除任何堆積的灰塵。

● 出風口和入風口的保養（每月一次或一次以上）

- 若要清潔出風口，請將電源開關設為“1”，並在冷風吹送時以刷子加以清潔。
- 若要清潔入風口，請將電源開關設為“0”，並在氣流停止時，使用刷子或吸塵器清除灰塵和頭髮。

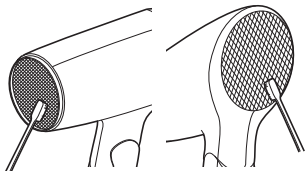

- 由於灰塵可能噴出，因此請加以留意。
- 當灰塵堵塞網孔時，溫度調節器開關將會運作，並經常地切換至冷風，而降低強風 / 柔風的效能。
- 溫度調節器開關是一種保護裝置。操作時可能會出現火花，但並不具任何危險。

規格

型號：EH-ND21

[僅限台灣]

| | |
|------|-----------|
| 電壓 | 110V 60Hz |
| 消耗電量 | 1200W |
| 附件 | 速乾護髮吹嘴 |

本產品只適合家居使用。

注意！

不遵守以下安全措施會導致手指受傷。

拉長把手

當手握把手或使用吹風機時『禁止接觸』下圖所示的陰影部分。

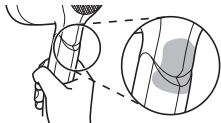

折疊把手

當折疊把手時『禁止接觸』下圖所示的陰影部分。



限用物質名稱及含量列表

| 設備名稱：吹風機，型號：EH-ND21 | | | | | | |
|-------------------------------------|------------|-----------|-----------|----------------------------|---------------|-----------------|
| 單元 | 限用物質及其化學符號 | | | | | |
| | 鉛 (Pb) | 汞 (Hg) | 鎘 (Cd) | 六價鉻 (Cr ⁺⁶) | 多溴聯苯 (PBB) | 多溴二苯醚 (PBDE) |
| 塑膠部件 | ○ | ○ | ○ | ○ | ○ | ○ |
| 金屬部件 | — | ○ | ○ | ○ | ○ | ○ |
| 電源線/配線 | — | ○ | ○ | ○ | ○ | ○ |
| 電動機 | — | ○ | ○ | ○ | ○ | ○ |
| 備考1. "○" 係指該項限用物質之百分比含量未超出百分比含量基準值。 | | | | | | |
| 備考2. "—" 係指該項限用物質為排除項目。 | | | | | | |

委製商：Panasonic Corporation

商品原產地：泰國

進口商：台灣松下銷售股份有限公司

公司地址：新北市中和區建六路 57 號

連絡電話：0800-098800

網址：<http://www.panasonic.com/tw/>

Panasonic Corporation
<http://www.panasonic.com>
©Panasonic Corporation 2010-2020