

# Panasonic

Rechargeable Shaver

電動剃鬚刀

## Operating Instructions

## 使用說明書

Model No. ES5821

型號 ES5821

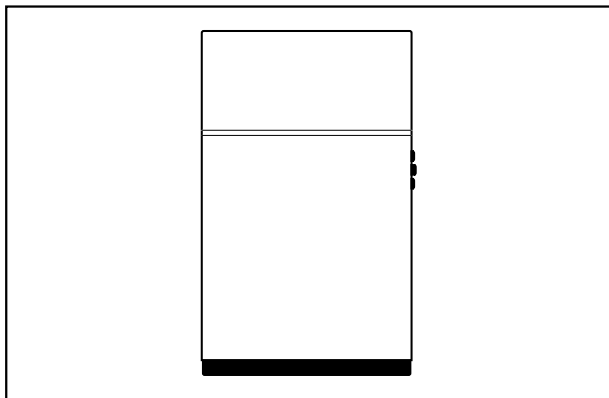

Before operating this unit, please read these instructions completely.  
Thank you for purchasing the Panasonic Rechargeable Shaver Model No.ES5821

在使用前，請仔細閱讀此說明書。

承蒙選購Panasonic ES5821型電動剃鬚刀，在此謹致謝意。

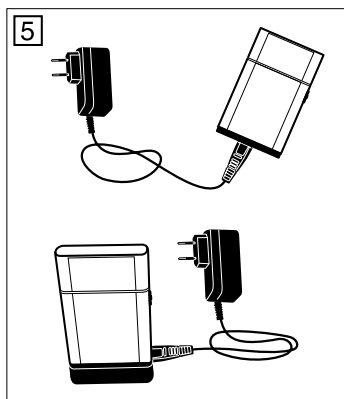
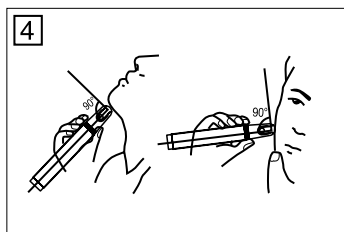
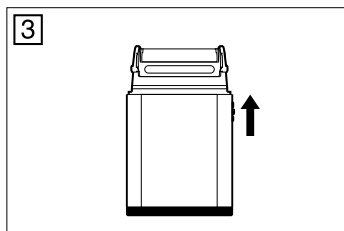
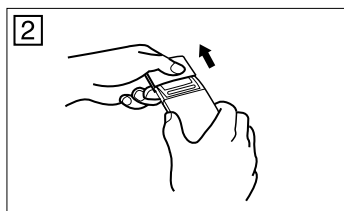
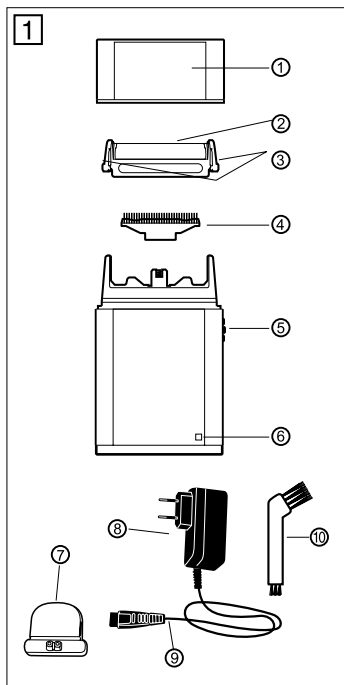

6

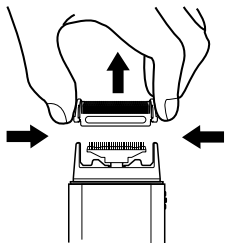

7

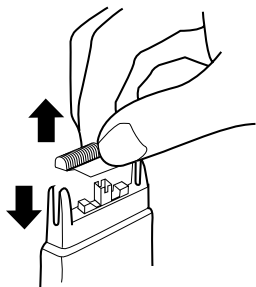

8

.....

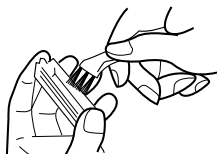

.....

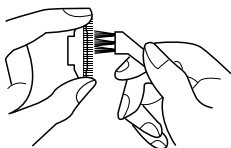

.....

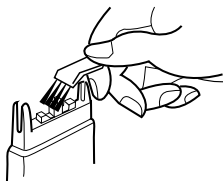

9

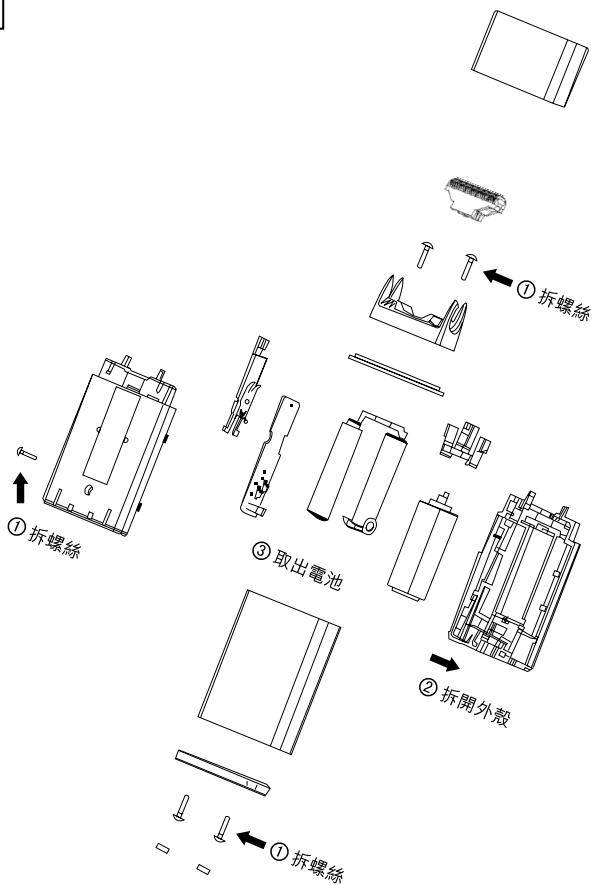



## Warning

Keep the shaver dry.

## Caution

1. Do not wash the shaver in water.
2. Do not charge the shaver in environments below 0°C (32°F) or above 40°C (104°F), in direct sunlight, near sources of heat, or in highly humid locations.
3. The system outer foil is especially thin and delicate. Please refrain from exposing it to excess pressure or heavy impact, to avoid damage or deformation. Please do not use the system outer foil if it is damaged or misshaped, to avoid harming your skin. Replace damaged system outer foil immediately.
4. Please do not wipe any part of the shaver with diluents, volatile fluids, or rubbing alcohol. Please apply a small amount of soap to a dry cloth to clean the shaver's body.
5. Please remember to always turn the shaver off after you have finished shaving, so as to avoid excessive battery draining, which may shorten battery life.
6. Please clean the shaver once every two or three days, completely removing any leftover hairs. Otherwise, blades' sharpness may be adversely affected.
7. Do not immerse the charging adaptor in water or wash with water.
8. Do not use anything other than the supplied charging adaptor for any purpose. Also, do not use any other product with the supplied charging adaptor. (See page 6.)
9. The supply cord cannot be replaced. If the cord is damaged the appliance should be scrapped.
10. This appliance is not intended for use by persons (including children) with reduced physical, sensory or mental capabilities, or lack of experience and knowledge, unless they have been given supervision or instruction concerning use of the appliance by a person responsible for their safety. Children should be supervised to ensure that they do not play with the appliance.
11. Charge the appliance correctly according to these Operating Instructions. (See page 6.)
12. This appliance contains battery that is only replaceable by skilled persons. Please contact an authorized service center for the details of repair.

13. The following symbol indicates that a specific detachable charging adaptor is required for connecting the electrical appliance to the supply mains. The type reference of power supply unit is marked near the symbol.



## Before Use

Your Panasonic shaver requires a little time to get used to, because your skin and beard need about a month to adjust to any new shaving method. Charge the shaver for about 12 hours before using it for the first time, or when it has not been in use for more than 6 months.

## Parts Identification

(see fig. 1)

- ① **Protective cap**
- ② **System Outer foil**
- ③ **System Outer foil release button**
- ④ **Inner blade**
- ⑤ **On/ Off switch**
- ⑥ **Charging indicator light**
- ⑦ **Charging stand**
- ⑧ **Charging adaptor (RE7-39)**
- ⑨ **Power cord**
- ⑩ **Cleaning brush**

## Using Your Shaver

- 1. Remove the protective cap (see fig. 2).
- 2. Slide the On/Off switch up to turn the shaver on (see fig. 3).
- 3. Lightly press the shaver against your skin at a right angle (see fig. 4). Start out by gently applying pressure to your face and moving against the grain of your beard. Stretch your skin with your free hand and move the shaver back and forth across your beard. You may gently increase the amount of pressure as your skin becomes accustomed to the shaver. Applying excessive pressure does not provide a closer shave.
- 4. Please turn the shaver off after use.
- 5. Put the protective cap back in place, to protect the system outer foil.

## How to Charge Your Shaver

(see fig.5)

- 1. Turn the shaver off.
- 2. Place the charging stand upright on a flat surface, and place the shaver into the adaptor. Then plug one end of the charging stand into

the adaptor, and the other end into an AC outlet. (The adaptor will adjust automatically to voltages between 100-240V.) You can also plug the adaptor directly into the bottom of shaver, and then plug the other end into an AC outlet.

3. The charging indicator light will light up, indicating that the shaver is charging.
4. When your shaver begins operating at a slower speed than usual, charging is necessary. You can fully charge the shaver in 8 hours.
5. A full 8-hour charge will supply enough power for about 7 shaves (3 minutes per shave for a normal beard).

## **How to Clean Your Shaver**

1. Turn the shaver off.
2. Remove the system outer foil by squeezing the system outer foil release buttons on either side of the shaver (see fig. 6).
3. Remove the inner blade by grasping it and pulling it straight away from the shaver (see fig. 7).
4. Clean the blade and the shaver body with the cleaning brush. Clean the system outer foil, blade frame, and shaver body with the long brush. Clean the inner blade with the short brush. Do not use the short brush to clean the system outer foil (see fig. 8).

5. After cleaning, return the blade and the system outer foil to their original place in the reverse order of removal described above.

## **Taking Care of Your Blades**

As the thickness of every user's beard is different, as is their use of the shaver, the degree of blade's wear and tear will differ from person to person. Users can decide when to replace their blade accordingly. However, if you use your shaver on a daily basis, it is recommended that you replace the system outer foil at least once a year, and replace the inner blade at least once every two years, to ensure the best shave possible.

### **Replacing the System Outer Foil**

(see fig. 6)

Squeeze the system outer foil release buttons to remove the system outer foil. To insert the new system outer foil, press it down until it snaps into place.

### **Replacing the Inner Blade**

Squeeze the system outer foil release buttons to remove the system outer foil (see fig. 6). Remove the inner blade by grasping it firmly and pulling it straight out away from the shaver (see fig. 7). Hold the new blade on either end and press it downward until it snaps into the shaver.

## **A Recommendation for Environmental Protection and the Recycling of Materials**

This shaver contains rechargeable nickel-cadmium batteries. Before disposing of this shaver, please make sure that you first remove the batteries.

The battery is to be disposed of safely.

Remove the appliance from the charging stand and adaptor, press the power switch to turn on the power and then keep the power on until the battery is completely discharged.

Disassemble the shaver as shown in figure 9, and then take out the batteries.

Insulate the  $\oplus$  and  $\ominus$  terminals by applying tape to them.

(To prevent short circuit of terminals).

Please make sure that, upon removal, batteries are disposed of at an officially assigned location, or a designated recycling center, to ensure that they are dealt with in a safe and environmentally friendly manner.

Before disposing of this shaver, we encourage you to seek the opinions of our dealers or an authorized service center, to extend this product's life as much as possible. Should you decide to dispose of this shaver, but do not wish to disassemble it and remove the batteries on your own, we encourage you to bring the shaver to an authorized service center, for battery removal and recycling by authorized personnel.

**BE SURE TO TURN THE SHAVER OFF BEFORE DISASSEMBLING IT AND REMOVING THE BATTERIES!**

## 警告

保持剃鬚刀乾燥。

## 注意事項

1. 本剃鬚刀禁止水洗。
2. 切勿在氣溫低於 0°C (32°F) 或高於 40°C (104°F)、受陽光直射、接近熱源或濕度很高的情形下進行充電。
3. 外刀網極薄而精密，請勿使其受到過大的壓力或衝擊力，以免變形或損壞。如果外刀網變形或損壞，請勿使用，以免損傷皮膚，同時應及時更換外刀網。
4. 請勿使用稀釋劑、揮發油或酒精揩抹剃鬚刀任何部分，而應使用乾布沾少許肥皂水清理剃鬚刀機身。
5. 請勿忘記關掉剃鬚刀開關，以免電池放電過多而縮短使用壽命。
6. 每隔兩天或三天請清潔剃鬚刀一次，把積留的鬍鬚去除乾淨，否則會影響刀具的鋒利程度。
7. 請勿將充電器浸入水中或用水清洗。
8. 請勿使用隨附充電器以外的其他裝置為本產品充電。此外，請勿使用隨附充電器為其他產品充電。  
(見第 10 頁)
9. 電源線無法更換。若電源線損壞，應棄置此電源供應器。
10. 本產品不宜供肢體、感官或精神上有障礙、或缺乏經驗及知識等人士（包括兒童）使用，必須有監護人從旁監督，並指導使用本產品，且能承擔使用者安全的責任。並應妥善照顧兒童，確保他們不會把玩這些產品。
11. 根據使用說明書將產品正確充電。  
(見第 10 頁)
12. 本產品包含僅能交由專業人員更換的電池。如需詳細的維修資訊，請洽詢Panasonic直屬服務站。
13. 下列符號表示需使用專用的可拆式充電器，將本電器連接至主電源。符號附近標示了充電器的類型參考。



## 準備使用

由於您的皮膚及鬍鬚約需一個月時間才能適應任何一種新的剃鬚方式，因此使用者須稍花時間以習慣使用松下剃鬚刀。首次使用本剃鬚刀或經6個月以上沒有使用時，請首先將剃鬚刀充電大約12個小時。

## 各部分名稱（見圖1）

- ① 保護蓋
- ② 外刀網
- ③ 外刀網釋放按鈕
- ④ 內刀頭
- ⑤ 開關
- ⑥ 充電指示燈
- ⑦ 充電座
- ⑧ 充電器（RE7-39）
- ⑨ 充電器連接線
- ⑩ 清潔刷

## 使用方法

1. 取下保護蓋。（見圖2）
2. 將開關向上滑動，以打開剃鬚刀電源。（見圖3）
3. 將剃鬚刀輕貼面部，放在與皮膚成直角位置（見圖4），用適當的力度逆著鬍子生長的方向剃鬚，請用另一隻手拉動臉上的皮膚並將剃鬚刀在鬍子上前後移動。當您的皮膚開始習慣本剃鬚刀時，您可以稍微增加下壓的力度，但施加過大的壓力並不能為您帶來更貼服的剃鬚效果。

4. 使用完畢後，請關閉剃鬚刀電源。
5. 蓋上保護蓋，以保護外刀網。

## 充電方法（見圖5）

1. 關閉剃鬚刀電源。
2. 將充電座放置在一個平整的地方，先將剃鬚刀插入充電座，然後將充電器插頭插入充電座，最後才將充電器插入交流電插座。（本充電器具有自動調適的100-240V電壓。）您亦可將充電器插頭直接插入剃鬚刀底部，然後再將充電器插入交流插座進行充電。
3. 充電指示燈亮起表示正在進行充電。
4. 當剃鬚刀出現運轉速度變慢情形時，應進行充電。剃鬚刀充滿電需要約8小時。
5. 剃鬚刀經8小時充電後，大約可供使用7次（剃普通鬍鬚，每次3分鐘）。

## 清理方法

1. 關閉剃鬚刀電源。
2. 同時按住兩側的外刀網釋放按鈕，取出刀網。（見圖 6）
3. 捏住內刀頭，往上垂直拉起，取出內刀頭。（見圖 7）
4. 用清潔刷清理刀具及機身，用長毛刷清理外刀網、刀框、機身，用短毛刷清理內刀頭。切勿使用短毛刷清理外刀網。（見圖 8）
5. 清理完畢後，按相反順序裝回刀頭、外刀網。

## 刀具的維護

每個人的鬚鬚濃度、使用方法不同，刀具的損耗情況也不一樣，使用者可根據實際情況確定刀具更換時間。但如果每日都使用剃鬚刀的話，為保持剃鬚刀的最佳狀態，建議每年更換一次外刀網及每兩年更換一次內刀頭。

### 更換外刀網（見圖 6）

按住外刀網釋放按鈕，將外刀網取出，然後將新的外刀網插入按下，直至固定為止。

### 更換內刀頭

按住外刀網釋放按鈕，取下外刀網（見圖 6），再用力捏緊內刀頭，將內刀頭從剃鬚刀內垂直拉出（見圖 7），然後手持刀頭兩端將新內刀頭垂直插入按下，直至固定為止。

## 環境保護與資源回收

本剃鬚刀內藏可充電的鎳-鎘電池，當您決定廢棄本剃鬚刀時，一定要事先將電池從機身中取出。

必須安全地丟棄電池。

從充電座和轉接器取下產品、按下電源開關開啟電源，然後持續開啟電源，直到電池完全沒電為止。

電池的取出方法如圖 9 所示，請按順序拆解剃鬚刀並取出電池。

在⊕與⊖端子貼上膠帶，使端子絕緣（避免端子短路）。

務必將取出的電池棄置於主管機構指定的地方或交給回收處理單位，以確保對電池的安全、環保化處置。

鼓勵您在決定廢棄本剃鬚刀之前，事先徵求經銷商或本公司指定維修店的意見，儘量延長剃鬚刀的使用壽命。當您決定廢棄本剃鬚刀又不想自行拆解剃鬚刀以取出電池時，鼓勵您將本剃鬚刀送往本公司指定的維修店，由維修店對剃鬚刀進行拆解並回收電池。

**注意拆解剃鬚刀、取出電池之前，一定要關閉電源！**

Panasonic Corporation  
<http://www.panasonic.com>