

Panasonic®

ENGLISH OPERATING INSTRUCTIONS

ROOM AIR CONDITIONER
CW-XV1813EA / CW-XV2413EA F569872

Before operating the unit, read these operating instructions thoroughly and keep them for future reference.

1 SAFETY PRECAUTIONS

Please observe these following safety precautions when using your air conditioner.

- Failure or negligence in observing these safety precautions could cause fire, electrical shock or personal injury.

WARNING This sign warns of risk of death or serious injury.

CAUTION This sign warns of risk of injury or damage to property.

This symbol (with a white background) denotes an action that is **PROHIBITED**.

These symbols (with a blue background) denote actions that are **COMPULSORY**.

INSTALLATION PRECAUTIONS

WARNING

Do not install, remove and reinstall the unit yourself.
Improper installation may cause leakage, electric shock or fire. Please engage an authorized dealer or specialist for the installation work.

Do not add or replace refrigerant other than the specified type.
It may cause product damage, burst and injury.

If the supply cord is damaged, it must be replaced by the manufacturer, its service agent or similarly qualified persons in order to avoid a hazard.

The room air conditioner must be earthed.

Improper grounding could cause electric shock.

Do not install the unit in a place where there are explosive gas leaks.

Gas leaks near the unit could cause fire.

Ensure that the drainage piping is connected properly.

Otherwise, water will leak out.

CAUTION

This sign warns of risk of injury or damage to property.

OPERATION PRECAUTIONS

WARNING This sign warns of risk of death or serious injury.

- Do not modify the length of the power cord or use an extension cord.
- Do not touch or operate with wet hands.
- Do not modify or damage the cord.
- Do not turn on the unit by inserting the power plug. Do not switch off the unit by pulling out the power plug.
- Avoid an extended period of direct airflow.
- Do not insert your fingers or other objects into the unit, rotating parts may cause injury.
- Do not try to repair the unit yourself.
- Plug in properly before operating and use a specified power cord.
- If abnormal conditions (burnt smell, etc.) occur, switch off and unplug the unit.
- Confirm to authorized dealer or specialist on usage of specified refrigerant type. Using of refrigerant other than the specified may cause product damage, burst and injury etc.
- This appliance is not intended for use by persons (including children) with reduced physical, sensory or mental capabilities, or lack of experience and knowledge, unless they have been given supervision or instruction concerning use of the appliance by a person responsible for their safety. Children should be supervised to ensure that they do not play with the appliance.

CAUTION This sign warns of risk of injury or damage to property.

- Do not use the unit for other purposes, than its intended use.
- Do not remove the power plug by pulling the cord.
- Do not block the air intake and outlet vanes.
- Do not splash or direct water at the unit.
- Do not expose the unit to direct sunlight during operation.
- Do not operate the unit without the air filter installed or when the front intake grille has been removed.
- Do not place any objects on the unit.
- Do not operate any combustion equipment near the unit's airflow area.
- Do not sit or step on the unit, you may fall down accidentally.
- Do not touch the sharp aluminium fin, sharp parts may cause injury.
- Switch off the breaker and unplug the unit from the socket if the unit will not be operated for a long period.
- Pay attention to any damages on the unit caused by extensive usage.
- Ventilate the room occasionally where the unit is installed.
- Unplug the power cord when cleaning the unit.

2 PART IDENTIFICATION

MAIN UNIT

Air inlet louvre • Cabinet

Air filter (behind the front intake grille) • Front grille

Front intake grille • (for CW-XV1813EA only) Power cord

Vertical airflow direction vane (Airflow direction adjustment up-down). The vertical airflow direction vane is controlled by positioning the vane to discharge the air upwards, downwards or straight on.

When the slide lever is in the : CLOSE ◀ VENT ▶ OPEN
"OPEN" position, the ventilation door opens to allow air, smoke or odours to be expelled from the room.

When the slide lever is in the : CLOSE ◀ VENT ▶ OPEN
"CLOSE" position, the ventilation door is closed and the air inside the room is circulated and conditioned.

Touch control panel

TEMPERATURE/TIMER setting pad • Display Panel • FAN SPEED selection pad • MODE selection pad

• TIMER pad • OPERATION OFF/ON pad • Timer SET/CANCEL pad • POWERFUL pad • AIR SWING pad

TYPE OF SIGNAL SOUND - One long "Beep" and one short "Beep". (Sound from the main unit.)

ACCESSORIES

• Remote control • Two R03 dry-cell batteries • Drain pan

Remote control

Signal Transmitter • OPERATION button • TIMER button • MODE selection button • AIR SWING button

TEMPERATURE/TIMER setting button • TIMER SET/CANCEL button • POWERFUL button • FAN SPEED selection button

Be sure to observe the following:

- Aim remote control at control panel on air conditioner when operating.
- Do not drop or throw the remote control.
- Do not place the remote control in a location that is exposed to direct sunlight or next to a heating unit or other heat sources.

• Maximum distance : 10 m

3 PREPARATION BEFORE OPERATING

NOTES:

- If the unit is not going to be used for an extended period of time, remove the power plug. Otherwise, approximately 2.5W of electricity will be used even if the unit has been turned off using the remote control.
- If operation is stopped, and to be restarted immediately, the unit will resume operation only after 3 minutes.

WARNING Ensure that the power plug is securely inserted. A loose plug may cause a fire or an electric shock.

HOW TO INSERT BATTERIES

1 Open the cover. 2 Insert the two batteries. 3 Close the cover.

CAUTION Do not use rechargeable (Ni-Cd) batteries because such batteries differ from the standard dry cell batteries in shape, dimension and performance.

ABOUT THE BATTERIES

- The batteries can be used for approximately one year.
- Be sure to replace the batteries with two new identical batteries.
- Remove the batteries if the air conditioner will not be used for an extended period of time.

OPERATION CONDITIONS

Use the air conditioner under the following conditions:

- Operating temperature range.

Continuous operation at over 90% high humidity may create condensation and result in waterdrops on the intake and outlet vanes.

(unit in °C)

	Indoor side		Outdoor side	
	D.B.T.	W.B.T.	D.B.T.	W.B.T.
Max. Temperature	32	23	43	26
Min. Temperature	16	11	16	11

NOTE: Humidity may exceed 90% D.B.T.: Dry Bulb Temperature W.B.T.: Wet Bulb Temperature

4 AIR CONDITIONER INSTALLATION

CHOOSING THE INSTALLATION LOCATION

- When installing, use the nearest power outlet. Make sure the power outlet is easy to reach so you can quickly disconnect your air conditioner in case of emergency.
- Ensure that the air conditioner is well supported, securely fastened, easily reachable and not obstructed.
- Avoid locations with: salty or sulphurous air, draughts, dampness and flammable gas.
- If you install the drainage system, be sure to channel the condensed water to a suitable location.
- Covers, obstructions and unsteady support may cause excessive operating noise and vibration.
- The rear end of the air conditioner is splash proof. You need not shield or cover it.



PREPARATIONS BEFORE INSTALLATION

DIMENSION

- There should not be any obstacles surrounding the unit.
- Prepare an installation hole slightly bigger than the cabinet size.
- Left and right sides of the unit should be at least 15cm away from the wall.

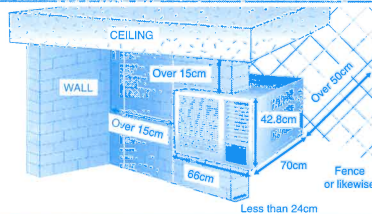

CAUTION POINT DURING INSTALLATION

When installing air-conditioner at glass window or thin partition, fix the vertical & side supporting bar to the concrete wall in order to support the weight of the air-conditioner and reduce the vibration that is being transferred to the glass window or thin partition.

This can minimize the noise problem caused by improper installation.

- Proposed to use 3/16" x 1-1/2" "angle-aluminium" for installation frame and 1/8" x 1-1/4" "angle-aluminium" for side supporting bar.

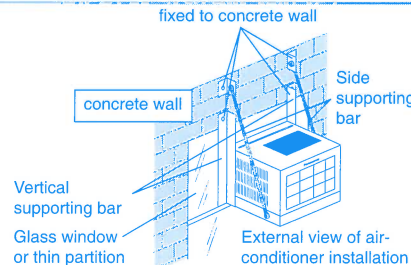

INSTALLATION PROCEDURES

- Remove the chassis locking bracket and screw.

- Slide the chassis out from the cabinet.

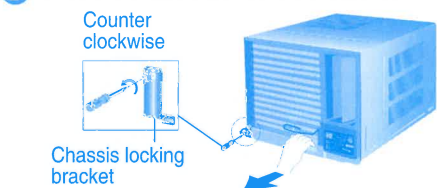

- Place cabinet into the installation hole.

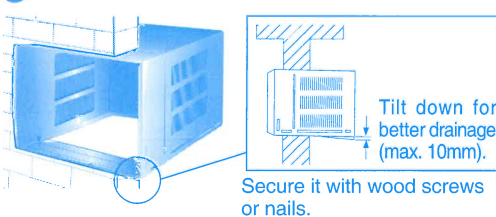

- Slide the chassis into the cabinet.

- Lock the chassis to the cabinet reusing the chassis locking bracket and screw.

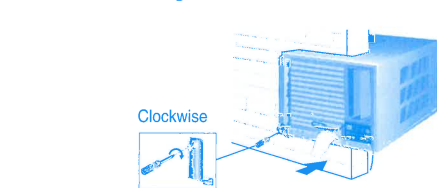

Depending upon the location of the AC outlet, route the AC cord to either the left or right side while installing the front grille.

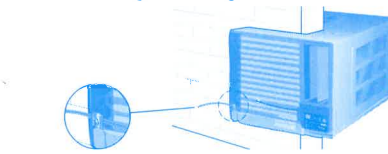

This figure shows the AC cord routed to the left side.

- Attach the front grille to the cabinet and fasten it with screws.

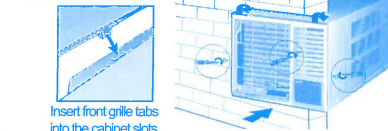

- Attach air filter to the front grille. (See anti-bacterial filter installation instructions included in this package)



- Insert hook of string in the hole provision of the intake grille. Slide the intake grille slightly to the right to reattach the tabs and then push it down to close tight.



REMOVAL OF FRONT GRILLE

- Remove the front intake grille. Pull up the front intake grille about 90° and slide it slightly to the left to unhook the tabs. Unhook string for intake grille.



- Remove the air filter. Tilt up and pull out the air filter by the holder.

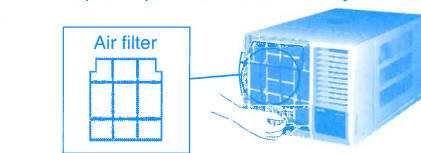

- Remove the front grille.

- Remove the screw on the front grille near the discharge grille and then the two screws on the side.
- At bottom right side of the front grille, press inward on cabinet near the power cord, and pull the grille outward to the right until right tab releases.
- At the bottom left side, push inward on cabinet and pull the grille outward to the left to release the left tab. Do not pull the bottom edge toward you more than 3 inches to prevent the two top tabs from damage.
- Slide the front grille upwards to loosen the two top tabs from slots at the top of the cabinet.

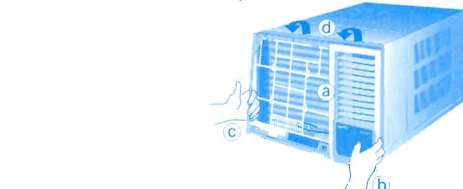

ELECTRICAL WORK

- Always use at the rated voltage and with a specific air conditioning circuit.
- This equipment must be earthed and strongly recommended to be installed with Earth Leakage Circuit Breaker (ELCB) or Residual Current Device (RCD). Otherwise, it may cause electrical shock or fire in case of malfunction.
- Time delay fuse or circuit breaker rating is 16 Ampere for CW-XV1813EA and 20 Ampere for CW-XV2413EA.
- Nominal cross sectional area of power supply wire must be 3 core x 2.5 mm² or above.
- The power supply must be from an independent circuit.
- All electrical installations must be made in accordance with local wiring and safety regulations wherever applicable.
- There must be a double pole switch with a minimum of 3.5 mm contact gap in the fixed installation circuit.
- Please engage an authorized dealer or specialist for the installation work.

CONDENSED WATER DRAINAGE

This air conditioner employs a "Slinger-Up System" which is designed to splash the condensed water on the condenser coil for maximum cooling efficiency, thus producing a splashing sound. If the splashing sound annoys you, you can provide an outside drainage by using the following procedure which may, however, cause a small loss of performance.

NOTE: If the unit is installed at coastal area, drainage of condensed water is recommended to prevent the condenser being corroded easily.

- Remove the rubber plug and chassis locking bracket from the cabinet. Then slide the chassis out from the cabinet.
- Install the drain pan.

INTERNAL VIEW

Remove the rubber plug

Chassis locking bracket

Counter clockwise

Scissors

Drain pan

Install the drain pan at the right corner of the cabinet using 2 screws.

- Connect a drain hose. Fit the drain hose to the drain pan.
- Slide the chassis back into the cabinet. Lock the chassis to the cabinet reusing the chassis locking bracket and screw.

EXTERNAL VIEW

Drain hose

Underside view with drain pan and hose in place.

NOTE: Drain hose or tubing can be purchased locally to satisfy your particular needs.



NOISE CONSIDERATION

- Select an installation location that can support the weight of the air conditioner and one that will not cause increased operating noise and vibration.
- Ensure that airflow and noise from the rear side of the unit (outdoor) when installed do not disturb neighbouring residents.
- Obstacles placed in front of the air outlet on the rear side of the unit (outdoor), or covers placed over it will cause excessive noise and deterioration in performance.

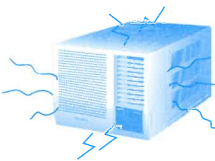

TRANSFERRING

- Repositioning or transfer of the air conditioner due to renovation or moving requires an additional service charge. Please consult your dealer before moving.

AIR CONDITIONER OPERATION

OPERATING THE UNIT

Start operation by pressing OPERATION.

The operation will turn on and the display panel will light up.

To stop the operation, press the OPERATION again.

The unit will stop operating and the display panel light will turn off.

SETTING DISPLAY TEMPERATURE

Press TEMP/TIMER ▲ or ▼ to set the display temperature.

The temperature can be set between 16°C and 30°C.

Recommended temperature: 26°C ~ 28°C

NOTES:

- The latest temperature setting will be memorized and will appear on the display the next time it's turned on.
- The display temperature selection is for display purpose only and does not indicate actual room setting temperatures. Your room temperature may not necessarily match the displayed temperature.

SELECTING OPERATION MODE

Press MODE to select the desired operation.

The indicator will light up and a "beep" sound will indicate changing setting.

COOL mode

To set room temperature to your preference of cooling comfort.

FAN mode

To provide air circulation without cooling the room.

SLEEP mode

To provide energy saving and comfort during Sleep

SELECTING FAN SPEED

Press FAN SPEED to choose the speed level of the fan.

The indicator will light up and the "beep" sound will indicate changing setting.

NOTE:

- The latest fan speed setting will be memorized and the indicator will light up the next time the unit is turned on.

ADJUSTING HORIZONTAL AIRFLOW DIRECTION

Press to select AIR SWING.

The air circulation will automatically move the vertical louvres left and right for better air distribution around the room.

NOTE:

Using your hands to adjust the direction may cause the louvres to malfunction. If this happens, stop operation immediately and restart.

NOTE:

Vertical adjustment of the airflow direction is done manually.

POWERFUL OPERATION

To obtain set temperature quickly:

- Press POWERFUL.
- To cancel this operation, press once more.
- After POWERFUL is selected, the operation will go on for 15 minutes, after that it will shift back to previous operation mode.

NOTE:

Sound emitted by the unit will be increased during POWERFUL operation due to increased of air volume.

Cooling	-3°C lower than set temperature (lowest limit 16°C)	Super High Fan Speed
---------	---	----------------------

SETTING THE OFF TIMER

When the air conditioner in operation:

Press the TIMER button.

The SET/CANCEL indicator light will blink awaiting for setting.

Press the TEMP/TIMER ▲ or ▼ button until the preferred hour of operation is reached.

Press the SET/CANCEL button to complete the setting. At this time, the SET/CANCEL indicator light is steady instead of blinking.

NOTE:

The hour reading will change back to the set temperature reading after 5 seconds. (You can also revert to temperature setting immediately by pressing the TEMP/TIMER ▲ or ▼ buttons again.)

CHECK TIMER SETTING DURING OFF TIMER

Press the TIMER button to check the remaining programmed timer setting. The figure will be displayed for 5 seconds then will automatically switch back to temperature setting.

NOTE:

The timer figure will change according to the time remaining (if you set it to turn off 3 hours from now, the timer will show "2" at an hour later).

CANCEL OFF TIMER SETTING

Press the SET/CANCEL button to cancel the timer setting. The SET/CANCEL indicator light will turn off. However the temperature remains displayed.

SLEEP MODE SETTING

The air conditioner will gradually increase the temperature during sleeping time. When the set room temperature is reached, it will maintain the set temperature for an hour and will shift 1°C up. The 1°C up will be maintained for an hour and then will shift 1°C up for a total of 2°C. The 2°C up will be maintained until the set time is consumed and then the unit will turn off automatically.

NOTE: The automatic shift of temperature (Max 2°C) is not indicated on the display panel.

Press MODE button to select Sleep mode. SLEEP LED lights on. SET LED blinking awaiting for confirmation. 7-SEGMENT LED DISPLAY show the last set duration time or the default time (8 hours) if the duration has not been set.

Note: If the TIMER button is pressed after selecting SLEEP, there will be no change or effect.

Note: If no other operation is performed within 10 seconds, sleep mode will cancel out and automatically return to Cool mode. SET LED stops blinking and COOL LED lights on. 7-SEGMENT LED display will show the temperature display.

Press TEMP/TIMER ▲ or ▼ to select the desired hour. (Range is 4 to 12 hours).

Press SET/CANCEL button to complete setting. SET LED stops blinking and lights on. Sleep mode is set.

Note: The hour display will change to temperature display 5 seconds after the SET/CANCEL button was pressed. Or press ▲ or ▼ buttons, the hour display will change to temperature immediately.

Press the TIMER button to check the remaining hour of Sleep mode operation. The hour is displayed for 5 seconds then will automatically switch back to temperature display. If the set duration time is '7', it will display '6', one hour after Sleep mode starts to operate.

Press SET/CANCEL button. Sleep mode will cancel out and automatically return to Cool mode. SET LED and SLEEP LED lights off. COOL LED lights on. Or press MODE.

NOTE: After the unit stops from Sleep Mode operation or after the unit resumes operating after a brownout, it will automatically reset to Cool Mode at the time the unit was turned on.

SETTING THE ON TIMER

When the air conditioner is OFF:

Press the TIMER button. The TIMER indicator light will blink to await for setting.

Press the TEMP/TIMER ▲ or ▼ button until the desired hour for operation is reached.

Press the SET/CANCEL button to complete the setting. At this time, the TIMER indicator light is steady instead of blinking.

The display will show the remaining hour to the start of the operation (if you set to turn on 3 hours from now, the timer will show "2" at an hour later).

When set time is reached, the air conditioner starts the operation under the previous setting mode and the TIMER indicator will light off. Now, the previous set mode and the fan speed will light up. Simultaneously, the display will show the setting temperature.

CHECK TEMPERATURE/MODE/FAN SPEED SETTING DURING ON TIMER

Press the TIMER button and the previous temperature setting will be shown.

Simultaneously, MODE and FAN SPEED indicator will light up. This indication will last for 5 seconds, and then the display will show the remaining time. MODE and FAN SPEED indicator light will turn off.

CHANGE TEMPERATURE/MODE/FAN SPEED SETTING DURING ON TIMER

Press the SET/CANCEL button to cancel the timer setting.

Press the OPERATION. Set the desired mode and the fan speed. Then press OPERATION button to stop operation.

Start the TIMER setting again by repeating the step from the "Setting the on timer" procedures.

NOTE: ON Timer will work only for COOL Mode and FAN Mode

CANCEL TIMER SETTING DURING ON TIMER

Press the SET/CANCEL button to cancel the timer setting. The SET/CANCEL indicator light will turn off. To operate the air conditioner before reaching the set timer:

- Press the SET/CANCEL to cancel the timer.
- Press the OPERATION button to turn on the unit.

HELPFUL INFORMATION & ENERGY SAVING HINTS

HELPFUL INFORMATION

- Auto Restart Control**
- Operation will automatically resume under the previous operation mode.
 - If the unit was set to TIMER mode or SLEEP mode, operation will not resume automatically.
- Timer Setting**
- When power failure occurs, the timer setting is cancelled. Once power returns, reset the timer.

ENERGY SAVING HINTS

- Setting the temperature 1°C higher save 10% electricity costs.
- Clean the air filter every 2 weeks. Regular cleaning of the air filter preserves efficiency.
- Keeping openings closed keeps cool air in and hot air out.
- Avoid direct sunlight and heat.
- For health reasons do not overcool your room.
- Your air conditioner's cooling capacity should match your room size.

CARE AND MAINTENANCE

WARNING

Always turn off the air conditioner and the main power supply before cleaning the unit.

Switch off the power supply if the unit is not going to be used for a long period of time.

- Clean the cabinet, front grille with a mild soap or detergent and lukewarm water.
- The front intake grille can be easily removed for cleaning purposes (refer to **Remove the front intake grille** procedures). Gently wash it with water and a sponge.
- The filter can be easily cleaned using a vacuum cleaner. Vacuum the front of the filter and then wash the rear with water. If it is badly soiled, wash with a mild household detergent.
- Do not clean with benzene, thinner, scouring powder or cloth soaked in caustic chemicals.
- If the unit is extremely dirty, heat transfer is less efficient and the unit may not cool effectively. Contact Shun Hing Electric Service Centre Ltd. for an annual check. (Annual check is not covered under warranty)
- If the air filter becomes clogged with dust, the cooling capacity will drop, and 6% of the electricity used to operate the air conditioner will be wasted.

NOTE: Do not dry the front panel or the air filter in direct sunlight. (Exposure to direct sunlight may discolour or deform the panel.)

PRE-SEASON INSPECTION

- Is the discharged air cold?*
After 15 minutes of operation, it is normal for the temperature difference between intake and outlet air to be more than 8°C for cooling.
- Are the air intake and outlet vanes of the indoor and outdoor side obstructed?*
- Are the remote control batteries weak?*

RECOMMENDED INSPECTION

- Usage over several seasons will reduce performance as the unit becomes dirty. A dirty unit may produce foul odours and dust may clog the dehumidifying drainage. Seasonal inspection is recommended in addition to regular cleaning. Consult Shun Hing Electric Service Centre Ltd..

BEFORE CALLING FOR SERVICE

BEFORE

Check the following points before calling for repairs or service. If the malfunction persists, please contact Shun Hing Electric Service Centre Ltd..

Condition 1

If the unit is too noisy during operation.

The following sounds are normal during operation:

- A low humming sound indicating that the unit is operating.
- A soft clicking sound when the compressor turns on and off.
- A flowing sound due to circulation of the refrigerant when the compressor is turned on.
- A splashing sound indicating condensation in the condenser coil.

If you hear other noises, please consult Shun Hing Electric Service Centre Ltd..

Condition 4

If water drips off the rear of the unit.

- Humidity is high.
- Condensed water is overflowing.
- To rectify the problem, mount a drain pan to the unit.

Condition 5

If water drips inside the room.

- The unit is tilted inward. To rectify this, tilt the unit slightly outward.
- Mount the drain pan if you prefer.
- The drain pan may be blocked.

To call Shun Hing Electric Service Centre Ltd. IMMEDIATELY

Turn off the power and contact Shun Hing Electric Service Centre Ltd. as soon as any of the following events occur.

- The circuit breaker frequently trips or the fuse blows regularly.
- If water or foreign objects have accidentally entered the air conditioner.
- If there is abnormal sound during operation.

NOTE:

- The enclosure opposing the room side is splash proof (IPX4).
- Do not install this appliance in a laundry room or other locations where water may drip from the ceiling, etc.
- If the supply cord is damaged or need to be replaced, it must be replaced by the manufacturer or its service agent or a similarly qualified person in order to avoid a hazard.

IMPORTANT

- * The wires in this mains lead are coloured in accordance with the following code:
- | | |
|------------------|-----------|
| Green and Yellow | : Earth |
| Blue | : Neutral |
| Brown | : Live |
- "As the colours of the wires in the mains lead of this appliance may not correspond with the coloured markings identifying the terminals in your plug, proceed as follows:
- The wire which is coloured green and yellow must be connected to the terminal in the plug which is marked by the letter E or by the safety earth symbol (⏏) or coloured green or green and yellow.
- The wire which is coloured blue must be connected to the terminal which is marked with letter N or coloured black.
- The wire which is coloured brown must be connected to the terminal which is marked with letter L or coloured red."
- (NOTE: Replacement or installation of power plug shall be performed only by authorised/qualified personnel.)
- * Only for CW-XV1813EA model.