

# Panasonic®

## Operating Instructions Refrigerator (For Household Use)

Model Number  
**NR-BT269**

ECONAVI  
INVERTER



English.....	2
Chinese.....	15

### Contents

#### Introduction

Safety Precautions.....	2
-------------------------	---

#### Installation

Installation.....	6
-------------------	---

#### Operation

Parts Identification.....	7
To use all features.....	8
- Control panel.....	8
- ECONAVI Operation.....	8
- Food Storage.....	9
- Using Tips.....	10
- Freezer Compartment.....	10
- Refrigerator Compartment.....	11

#### Appendix

Cleaning, removing and re-installing.....	11
Troubleshooting.....	13
Specifications.....	14



Panasonic Corporation  
Made in Indonesia  
印尼製造

Printed in Indonesia  
於印尼印刷  
ARAH1E202701



Thank you for purchasing this Panasonic product.

- Before operating this unit, please read these instructions completely.  
**Before using this product, please pay particular attention to the “Safety precautions” section (Pages 2 to 5) for safe use.**
- Please ensure the date and name of store of purchase are stamped in warranty card and keep it stored together with these operating instructions in a safe place for future reference.

## Introduction

### Safety Precautions



#### WARNING

This expression presumes possibility of a death or serious injury.



This sign means prohibited action



This sign means required action



This sign means do not disassemble



#### CAUTION

This expression presumes possibility of a personal injury or property damage.



R600a

iso-butane

Risk of Fire /  
Flammable materials.



#### WARNING

#### For power plug and cord...



- Periodically wipe the power plug with a dry cloth. (Dust accumulated on the plug of a refrigerator that operates continuously leads to reduced insulation due to moisture and may cause fire.)
- Plug into a wall outlet of the rated voltage on its own with the rated current and insert plug fully.
- Connect to an exclusive wall outlet for the refrigerator only. Avoid connecting other appliances to the same wall outlet. Unroll entire length of the cord before plugging in.
- Unplug the unit when cleaning the refrigerator.
- If the supply cord is damaged, it must be replaced by the manufacturer, its service agent or similarly qualified persons in order to avoid a hazard.
- Please ensure minimum clearance of 10 cm for air ventilation and prevent damage to the power cord.

#### For power plug and cord...



- Do not let the cord get damaged.
- Do not insert or disconnect the power plug into/from the wall socket with wet hands.
- When positioning the appliance, ensure the supply cord is not trapped or damaged.
- Do not locate multiple portable socket-outlets or portable power supplies at the rear of the appliance.

#### When recycling the product...



- Before taking the refrigerator to be recycled, please remove all the door gasket to prevent locking a child in it.
- The operating instructions should be handed over to any person who would use or handle the refrigerator whenever the refrigerator would be transferred to another location and delivered to a recycling plant.

## 附錄

### 技術規格

型號		NR-BT269
急凍等級		※ ※ ※ ※
容量 (公升)	合計	263/221
總容量/儲存量 (IEC 62552)	急凍室	67/42
	冷藏室	196/179
外形尺寸 闊 x 深 x 高 (毫米)		550 x 600 x 1580
雪種類型		R600a
淨重 (公斤/磅)		46/101
製冷系統		無霜製冷。
額定電壓 (伏特) 額定頻率 (赫茲)		請參考貼於雪櫃門上或櫃體背面的額定標籤

## 附錄

### 蔬菜箱

每3個月一次

#### ■ 取出

- ① 將箱體向前拉，直至到達止動器末端。
- ② 輕力抬起箱體前端並完全取出。

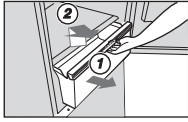

#### ■ 裝嵌

- ① 將箱體嵌入支架。
- ② 將箱體輕力抬起並向前推至末端。

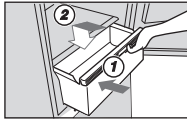

#### 通知

- 為儲存蔬菜與水果並保持其維生素，請在使用或清潔蔬菜箱後將其推至鎖好狀態。

### 疑難排解

若出現以下情況	檢查此處。
雪櫃無法運轉。	<ul style="list-style-type: none"><li>檢查插頭及牆上電源插座狀況是否良好。</li><li>檢查電源保險絲或室內配電線是否存在問題。</li><li>檢查時請拔除插頭，7分鐘後再重新插回。</li></ul>
雪櫃溫度不夠低。	<ul style="list-style-type: none"><li>檢查以確保控制面板顯示在正確的位置。(P.21)</li><li>檢查以確保雪櫃未負荷過多或冷藏了任何熱食。</li><li>雪櫃是否直接曝露在陽光下或靠近熱源？</li><li>雪櫃門是否完全關上？</li><li>雪櫃是否打開過於頻繁？</li></ul>
櫃體/櫃門表面內部及外部產生水汽。	<ul style="list-style-type: none"><li>天氣潮濕或空氣流通不良時，櫃體外部可能有水氣。</li><li>如果雪櫃內出現冷凝，請檢查櫃門是否完全關上。</li><li>雪櫃是否開啟過於頻繁或開啟很長一段時間？</li><li>雪櫃內部是否冷藏了熱食？</li></ul>
雪櫃產生噪音。	<ul style="list-style-type: none"><li>檢查雪櫃是否位於穩固，平坦的地板上或是否安裝正確。如果需要，使用可調節櫃腳調平雪櫃。(P.19)</li><li>檢查雪櫃是否與其他物體接觸。</li><li>相應部件溫度調整導致雪櫃內的碎裂聲音屬正常現象。</li><li>安裝完畢後，雪櫃可能發出嘈雜的噪音。待雪櫃冷卻後，噪音會變低。</li></ul>
食品變為冰塊狀	<ul style="list-style-type: none"><li>是否將食物放在冷空氣出風口旁邊？</li><li>如果溫度控制已設定為「3」，請嘗試將其調整為「1」設定。</li></ul>

## Introduction

### Safety Precautions

#### When recycling the product...



- Cyclo-Pentane is used for insulation of this refrigerator and flammable gas is used for refrigerant. When disposing of this unit, please discard it by the proper method and do not dispose of the unit by burning.
- The warning labels mentioned above should be kept throughout the life of the refrigerator.

In order to prevent fires, electrical shocks, explosion, injuries, etc.



#### In case of emergency...



- Maintenance work must only be carried out at workshop by well-trained maintenance worker.



- Do not store explosive substances such as aerosol cans with a flammable propellant and chemicals or scientific specimens in the appliance.



## WARNING



- Do not use electrical appliances such as a deodorizer in the refrigerator. Leaked refrigerant may catch fire from a spark of electrical contacts and may cause an explosion.

- Do not use electrical appliances inside the food storage compartments of the appliance, unless they are of the type recommended by the manufacturer.



- Do not use mechanical devices or other means to accelerate the defrosting process, other than those recommended by the manufacturer.
- Do not disassemble, repair or modify the refrigerator by yourself. If you want to repair the refrigerator, please consult your dealer or authorized service center.

#### On top of the refrigerator...



- Do not put anything on top of refrigerator. Otherwise, it may fall due to vibration of the machine. You may be injured.

#### When installing...



- Do not install the product in locations exposed to water.
- Provide a grounding connection or install a ground-fault interrupter when the product is installed in a humid or wet location. (Contact your distributor.)
- Do not block the ventilation port of the refrigerator or spaces around it. Leaked refrigerant may cause a fire and explosion.
- Keep ventilation openings, in the appliance enclosure or in the built-in structure, clear of obstruction.



- For safety it should be checked that the ground connection system in the house has been installed correctly.

## Introduction

### Safety Precautions

#### When using...



- Do not let any children hang or ride on the refrigerator door, the unit may turn over and cause an accident.
- Do not apply water on the body or interior. Electrical insulation could deteriorate and may cause shocks or fire.
- Do not allow any sharp objects to come into contact with the refrigeration system behind and inside the refrigerator. The flammable refrigerant may catch fire and lead to an explosion.
- Do not touch the compressor or pipes because of high temperatures. There is a risk of burns injury.
- Do not spray combustible chemicals near the refrigerator.



- If you detect a burning smell, disconnect the power plug.
- If you detect a gas leak from the cooling range, ventilate the kitchen.
- In case the refrigerant circuit is damaged, do not use any electric appliances or fire equipment nearby, and open all windows to provide good ventilation. Please also contact your local maintenance agent to follow up.
- Refrigerator LED lamp.  
The refrigerator LED lamp is designed specially for this product, it does not function on individual replacing. If replacement is required, please contact your dealer or authorised service agent.



- This appliance is not intended for use by persons (including children) with reduced physical, sensory or mental capabilities, or lack of experience and knowledge, unless they have been given supervision or instruction concerning use of the appliance by a person responsible for their safety.
- Children should be supervised to ensure that they do not play with the appliance.



## CAUTION

#### When storing food...



- Do not freeze glass bottles, that there is a risk of injury. (If the liquid in a glass bottle is frozen and broken, you may be injured.)
- Do not touch frozen foods or containers (especially metallic) with wet hands.
- Do not eat any smelling or colour-changed food. Rotten food may cause illness.
- Do not subject glass trays to high impact. (Otherwise those glass trays may break and you may be injured)



- Food containers must reach the bottom of the door shelves.
- The foods must not protrude from the shelf.

#### When opening/closing the doors...



- Do not open the refrigerator doors when someone is in the vicinity of the refrigerator.
- Mind the gap between the doors. They may nip your hand while closing the door.
- Do not push drawers by holding them at the top.
- Be careful not to place your feet under the bottom drawer.

## 附錄

至少每月清洗一次櫃門墊圈。

用柔軟的濕布擦拭乾淨。雪櫃鉸鏈側的櫃門墊圈塗有石油凝膠，請格外留意，切勿擦掉。

塗有石油凝膠的位置。

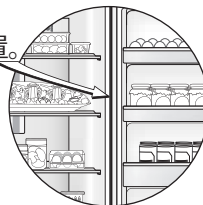

#### 注意事項

「櫃門墊圈」必須由授權服務代理進行更換。清潔時，如果櫃門墊圈掉落，可將其按壓回凹槽內。

#### 要求

請勿使用以下物品進行清潔。(以免表面刮花。)



廚房用清潔劑  
(可使塑膠破裂！)

鹼性或弱鹼性



清潔劑或肥皂粉



洗滌器



熱水



汽油，稀釋劑，  
酒精，酸，石油

用乾布擦拭控制面板。

用濕柔軟的布擦拭櫃門表面。

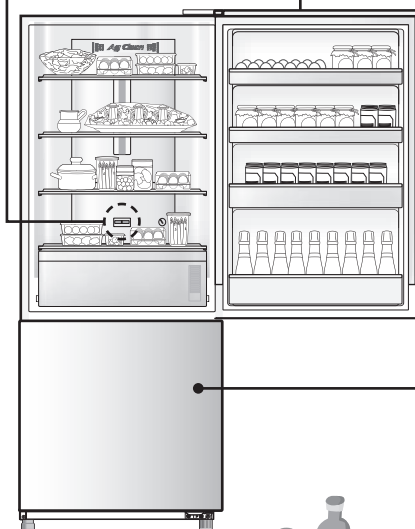

#### 門架

每3個月一次



#### ■ 移除

抓住門架左右兩側，再慢慢向上舉起直至鬆開。

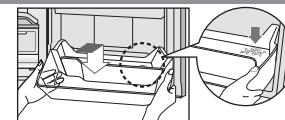

#### ■ 連接

將每個門架水平放置，右側有[> PS <]標記，再向下推，直至鎖好為止。

#### PC玻璃托盤

每3個月一次

#### ■ 取出

① 抬起托盤背面並向外拉。一旦托盤的突出部分脫離軌道，便將其取出。

#### ■ 連接

② 推送托盤直至到達末端鎖定。

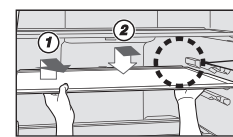

突出部分

軌道

玻璃托盤

#### 注意

- 拆除蔬菜保鮮格之上的托盤時，請先拉出蔬菜保鮮格，然後再如上所述拆除托盤。
- 假若裝上托盤且其不鎖定，確保您裝上正確的托盤。
- 托盤由玻璃製成，極重。  
請小心搬運，以免掉落而造成任何損壞或傷害。  
安裝托盤時，請將其突出部分朝下並插穩。



## 操作

### 使用全部功能 急凍室

#### 製冰

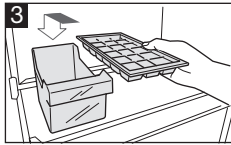

製冰  
將冰盤放入冰箱內，  
等待製冰完成。

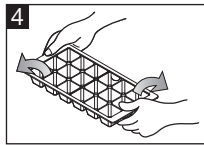

取出冰塊  
沿相反方向旋轉冰盤。  
(將冰塊倒入冰櫃。)

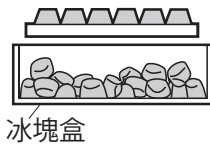

冰塊盒

### 冷藏室

可從頂部改變第二托盤的位置。

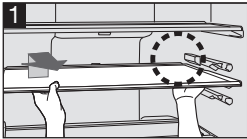

抬起托盤後部並向  
前拉。

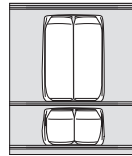
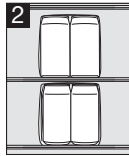

以反轉步驟將托盤  
插入所需位置。

#### 要求

- 玻璃架極重。  
請小心搬運，以免掉落而造成任何損壞或傷害。

## 附錄

### 清洗、拆卸及重新安裝

清洗或進行維護前，請務必從電源插座拔出電源插頭。請勿用濕手連接或斷開電源插頭。斷開插頭時，請7分鐘後再重新插入。否則，壓縮機可能無法工作。

#### 清洗

雪櫃弄髒後，立即清洗！

在雪櫃內表面的污漬變硬之前，快速將其擦掉。特別是煮食油可能會導致塑膠破裂，且柑橘汁可能會導致雪櫃褪色，當污漬無法輕鬆擦除時，可用中性廚房用清潔劑將布稍微浸濕進行擦拭。然後，用布輕蘸清水擦拭。



偶爾清潔可拆卸部分...

冰盤每週一次。作為指引，每三個月取出托盤櫃門擱架等，並浸泡入溫水內進行清洗。



## Introduction

### Safety Precautions

#### When cleaning...



- Do not place your hands or feet beneath the bottom of the refrigerator.
- Be cautious of hot copper pipe inside pan water eva when removing it.
- Do not clean the refrigerator with chemical substance or liquid. It will cause damage and have corrosion on the surface.

#### When moving or transporting the refrigerator...



- Do not transport the refrigerator in a horizontal position. Laying the refrigerator horizontally may damage the piping. If any damage is noticed, do not touch the refrigerator. Avoid using fire and ventilate the room and contact the service agent immediately.



- Apply protective covering, etc. to floors with a fragile surface.
- Hold the carrying when transporting the refrigerator.



### Caution for using

#### When using...



- Do not place warm/hot foodstuffs in the refrigerator. Store warm food and drinks after they have cooled.
- Do not open refrigerator frequently or leave it open for long time in order to prevent water dripping inside and waste energy.

#### When the refrigerator will not be used for a long period of time...



- Unplug the refrigerator and take out all the food in the refrigerator.
- Wipe off all the water and open the refrigerator to keep it dry.

### This appliance is intended to be used in household and similar applications such as

- staff kitchen areas in shops, offices and other working environments;
- farm houses and by clients in hotels, motels and other residential type environments;
- bed and breakfast type environments;
- catering and similar non-retail applications.

## Installation

(Before using for product.)

### Installation

#### Do not install the unit on the following locations :

- Locations subject to heat and direct sunlight (The cooling power will be reduced and electricity wasted.)
- Poorly ventilated locations with high humidity (it may become rusted and cause leakage current.)
- Locations where the surface is unstable and slanted  
→ On carpet, mats, or vinyl floors, place a plate underneath the refrigerator.
- Locations not allowing the power plug to be cleaned easily (Dust accumulated may cause a fire.)

#### Refrigerator doors should not be opened during the interior cooling process.

The doors should not be opened until the interior has cooled until the interior has cooled down sufficiently. (Warm air flowing into the interior will block the cooling function.)



#### Please wait until the interior has cooled down.

- It may take approximately four hours to cool down the interior.
- It may take 24 hours or more to cool down the interior and achieve equilibrium.

#### Has a heat radiating space between provided around the refrigerator ?

10 cm or more  
at the back of  
the refrigerator

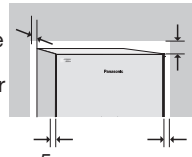

30 cm or more  
above the  
refrigerator

5 cm or more  
both left and right

#### Have any measures taken against tipping due to earthquakes ?

In order to prevent the refrigerator from tipping, permanently fix it by using belts, etc.



#### Fix the refrigerator.

Turn the adjuster bolt (right side) until they reach the floor to stabilize the refrigerator.

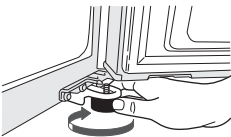

### Request and notices

#### Do not peel the seal on the back.

Otherwise, the cooling performance may deteriorate. If you have peeled it, then cut a cloth packing tape into a square and paste it onto the refrigerator.

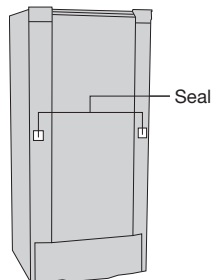

- The first operation of the compressor or the fan will cause a little bit noise but it is normal as it is working in high-speed. Once the interior cool down, the sound will become smaller and normal.

## 操作

### 使用全部功能

#### 使用提示



節能第一步：  
不要浪費冷氣！

溫熱的食物及飲品可在室溫冷卻之後再存放入雪櫃。

否則，溫熱的食物及飲品會使雪櫃隔間裏的溫度升高，同時亦會影響其他食物的新鮮度。



出現冷凝時。

- 蔬菜箱的濕度極高，可能會出現冷凝。只需擦去水滴即可。

明智選擇存放食物於雪櫃裏。

- 存放在陰涼處就足夠！



例如，不需要將原隻洋蔥或薯仔等放入雪櫃存放（夏天除外）



請勿將食物裝滿雪櫃的隔間而不留間隙。否則會影響冷氣流動。食物之間應留有足夠的空間。

請勿將食物置放於冷氣出口！

如冷氣不能擴散到雪櫃隔間的每個角落，則裏面的隔間將不能被充分地冷卻，而且會更加耗電



- 只需要在食用之前冷卻即可！



原隻熱帶水果過度冷卻可能會出現變色或令維他命被破壞。

推薦使用密封容器進行儲存！

防止內部變色！



- 切削柑橘類水果  
(→櫃內膠料可能會褪色變成白色。)

防止異味擴散！



- 大蒜或者其他氣味很大的蔬菜  
(→氣味會蔓延至附近其他的食品。)

### 急凍室

#### 製冰

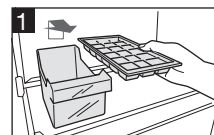

取出冰盤  
取出冰盤。

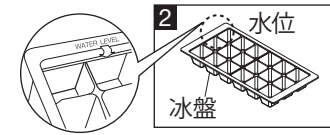

加水  
將水加至「水位」線。

## 操作

### 使用全部功能

#### 食物儲存

- 為長時間保持食物質量，請將食物儲存於合適的位置。

#### 儲存食物時...

- 諸如蔬菜，水果及新鮮食物之類，急凍和冷藏之前，應該用盒子包裹或包裝。
- 如果將高濕內容物放入雪櫃，則應密封並包裹以防出現水滴及結霜。
- 飲用水和飲料瓶應密封以防產生異味。
- 將水果及蔬菜儲存在蔬菜箱，可鎖住水分，有助於長時間保持食物質量。



#### 如何分別儲存這些不同的食物？

約  $0^{\circ}\text{C}\sim 5^{\circ}\text{C}$  用於常規或臨時儲存即將食用的食物及飲品。

約  $0^{\circ}\text{C}\sim 5^{\circ}\text{C}$

冷藏室



高濕度可保持果蔬新鮮多汁。

約

約  $3^{\circ}\text{C}\sim 8^{\circ}\text{C}$

蔬菜箱



用於儲存急凍或乾製食品。

約

約  $-23^{\circ}\text{C}\sim -18^{\circ}\text{C}$

急凍室



- 當設定為「2」（中）時，溫度可能會根據使用條件略有變化。

## Operation

### Parts Identification

- ① REFRIGERATOR COMPARTMENT
- ② FREEZER COMPARTMENT
- ① LED Lamp
- ② Refrigerator Temperature Control
- ③ Cold Air Control
- ④ Glass tray
- ⑤ Vegetable case
- ⑥ Ice tray
- ⑦ Ice box
- ⑧ Case FCB
- ⑨ Egg tray
- ⑩ Egg shelf
- ⑪ Free pocket
- ⑫ Door gasket PC
- ⑬ Bottle shelf
- ⑭ Tray FC
- ⑮ Door gasket FC
- ⑯ Leg shell
- ⑰ Adjuster bolt
- ⑱ Pan Water Eva
- ⑲ Compressor

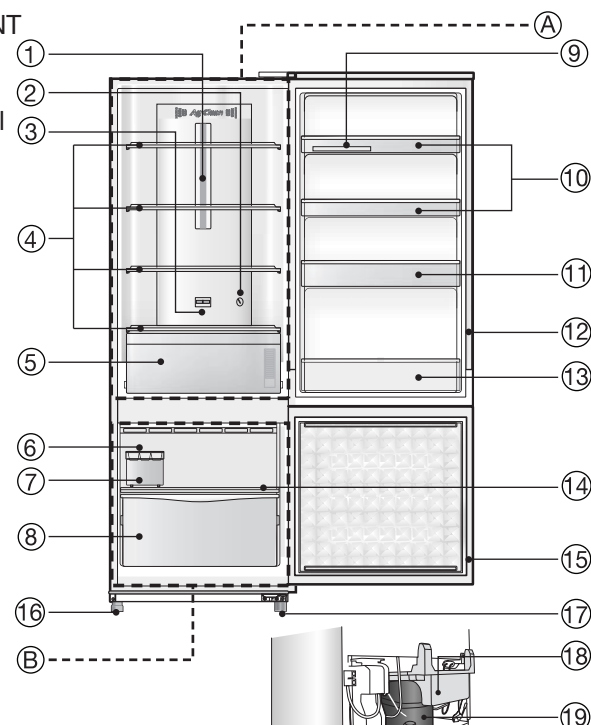

Product view from behind

### Control panel (P.8)

#### COLD AIR CONTROL

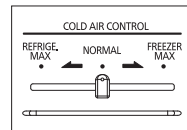

#### REFRIGERATOR TEMP. CONTROL

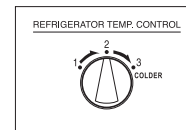

- Setting at time of purchase.
- Do not subject the control panel to a strong impact, or hit it with a hard object. (The Surface may be cracked or scratched)

### ■ SPECIAL FEATURE

#### • NON-CFC

This unit uses totally NON-FLON MATERIALS both for refrigerant (iso-butane (R600a)) and for insulation (Cyclo-Pentane). These materials do not damage the earth's ozone layer and has almost no effect on global warming.

#### • INVERTER

In accordance with temperature change inside the compartment, the compressor will run at different speeds. When the temperature inside the refrigerator is stable, the compressor will run at lower speed to save energy and lower noise. When powerful cooling is required, the compressor will run at a higher speed.

## Operation

### To use all features

#### Control Panel

##### ■ Temperature setting and guide of temperature

The temperature can be adjusted for 1-3 levels.

Operate the [REFRIGERATOR TEMP. CONTROL] when changing the temperature of refrigerator compartment.

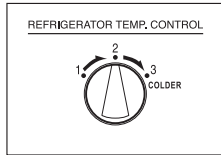

Button	TEMP. CONTROL REFRIGERATOR COMPARTMENT
"1" (Min)	Higher than "2" by approximately 2°C ~ 3°C
"2" (Med)	Approximately 3°C ~ 5°C
"3" (Max)	Lower than "2" by approximately 2°C ~ 3°C

Operate the [COLD AIR CONTROL] by sliding the lever to adjust cold air control.

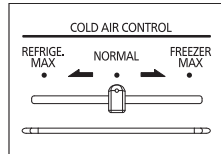

Button	COLD AIR CONTROL
"REFRIG. MAX"	Refrigerator compartment takes priority.
"NORMAL"	Cold air condition is normal.
"FREEZER MAX"	Freezer compartment takes priority.

**Normally, use the refrigerator with the temperature set to "2" and "NORMAL" (Med).** (If the temperature control of the refrigerator compartment or freezer compartment is set to other than "2" and "NORMAL" (Med), ECONAVI does not operate.)

- The temperature control can vary depending on the environment and amount of food stored in the refrigerator
- Cold air control lever may become unsmooth after long usage. More force need to be applied.

#### ECONAVI Operation

This model also has ECONAVI mode, but it does not feature ECONAVI lamp and light intensity sensor.

The refrigerator detects the opening and closing of the refrigerator door to automatically control operation to ensure maximum energy saving.\*1

##### ■ ECONAVI operation

- The refrigerator learns the lifestyle patterns of your family from door opening and time periods of infrequent use to maximise energy efficiency.
- The refrigerator learns your lifestyle patterns from the previous 3 weeks of use and uses that data from the 4<sup>th</sup> week onwards.

##### ■ Setting for enabling ECONAVI operation

- ECONAVI operation is automatically enabled when the temperature control for both the refrigerator and freezer compartment is set to "2" and "NORMAL" (Med).
- It is not possible to force to start of the ECONAVI mode.

#### Remark

\*1 The effectiveness of the ECONAVI mode is depended on the ambient temperature and the number of times the refrigerator door is opened and closed and the state in which food is stored.

## 操作

### 控制面板

#### 冷氣控制

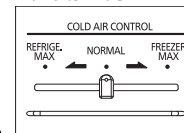

#### 雪櫃溫度控制

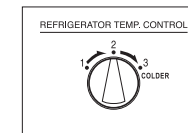

- 購買時設定。
- 請勿讓控制面板受強烈衝擊，或用硬物撞擊。(表面可能開裂或刮傷)

#### ■ 特殊功能

##### • 無氟製冷

本機使用完全無氟材料作為製冷劑（異丁烷（R600a））及絕緣材料（環戊烷）。該等材料不會破壞地球的臭氧層，對全球變暖幾乎沒有影響。

##### • 逆變器

根據室內的溫度變化，壓縮機將以不同的速度運行。當雪櫃內部溫度穩定時，壓縮機將以較低的速度運行，以節能減噪。當需強力冷卻時，壓縮機將以更高的速度運行。

### 使用全部功能

#### 控制面板

##### ■ 溫度設定及溫度指引

溫度可調節1-3級。

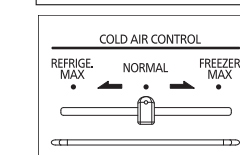
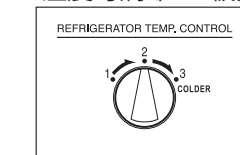

改變冷藏室溫度時，操縱「雪櫃溫度控制」

按鈕	急凍室溫度冷藏室溫度
"1" (小)	比「2」高大約2°C~3°C
"2" (中)	大約為3°C~5°C
"3" (大)	比「2」低大約2°C~3°C

滑動控制桿操作[冷氣控制]以調節冷氣控制。

按鈕	冷氣控制
"REFRIG. MAX"	冷藏室優先。
"NORMAL"	冷卻條件正常。
"FREEZER MAX"	急凍室優先。

正常情況下，冰箱使用溫度設定為「2」及「正常」（中）。  
(如冷藏室或冷凍室的溫度控制設定並非為「2」及「正常」（中），則ECONAVI不運作。)

- 雪櫃溫度親乎環境，室溫和食品儲諸存量而定。
- 冷氣控制桿長期使用後可能會變得不平滑。可能需施加更多力量。

#### ECONAVI操作

該型號還有ECONAVI模式，但無ECONAVI燈及光照感測器。雪櫃檢測雪櫃門的開關，自動控制運行，以確保節能最大化。\*1

##### ■ ECONAVI操作

- 雪櫃透過開門及不經常使用的時間段了解閣下家庭的生活方式，以最大幅度提高能源利用率。

冰箱透過前3週的使用紀錄了解閣下的生活方式，並從第4週起開始使用這些數據。

##### ■ 啟動ECONAVI操作的設置

- 當雪櫃及冷凍室的溫度控制設定為「2」與「正常」（中）時，自動啟用ECONAVI操作。
- 無法強行啟動ECONAVI模式。

附註 \*1 ECONAVI模式的有效性取決於環境溫度與雪櫃門開關次數及食物的儲存狀態。 21



## 安裝

(本產品使用前。)

### 安裝

#### 要求及注意事項

切勿剝離背面的密封件。

否則，可能會降低製冷效能。如果已剝離掉密封件，請將牛皮膠布剪成正方形並黏於雪櫃上。

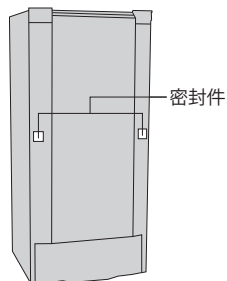

- 在安裝後，噪音變大，這是因為雪櫃內部還沒有降溫，壓縮器或風機以高速旋轉運行，但是這種現象是正常的。(雪櫃內部冷卻後，噪音會變小。)

## 操作

### 部件識別

- ① 冷藏室
- ② 急凍室
- ③ LED燈
- ④ 雪櫃溫度控制
- ⑤ 冷氣控制
- ⑥ 玻璃托盤
- ⑦ 蔬菜箱
- ⑧ 冰塊盤
- ⑨ 冰塊盒
- ⑩ 急凍格
- ⑪ 儲蛋格
- ⑫ 雞蛋架
- ⑬ 保鮮袋
- ⑭ 櫃門墊圈PC
- ⑮ 瓶架
- ⑯ 急速室置物架
- ⑰ 櫃門墊圈FC
- ⑱ 腳罩
- ⑲ 可調節櫃腳
- ⑳ 排水托盤
- ㉑ 壓縮機

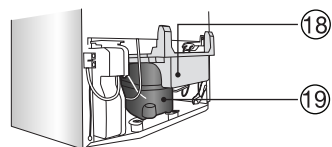
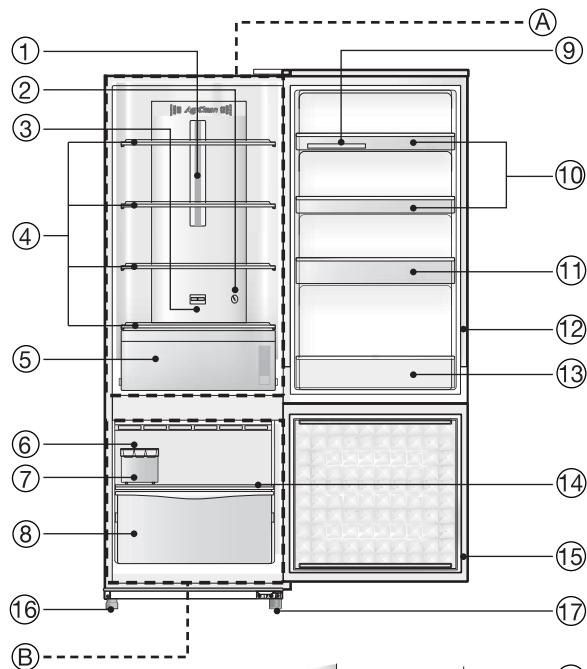

產品背部視圖

## Operation

### To use all features

#### Food Storage

- In order to preserve food quality for long time, please store it in the right place.

#### When storing food...

- Foodstuff such as vegetable, fruits and fresh food should be wrapped or pack in box before freezing and refrigerating.
- If you will put high moisture content into refrigerator, should be sealed and wrapped to prevent dew and frost.
- Drinking water, beverage bottles should be sealed to prevent the odour.
- Store fruits and vegetables in vegetable case, where trapped moisture helps preserve food quality for longer time periods.

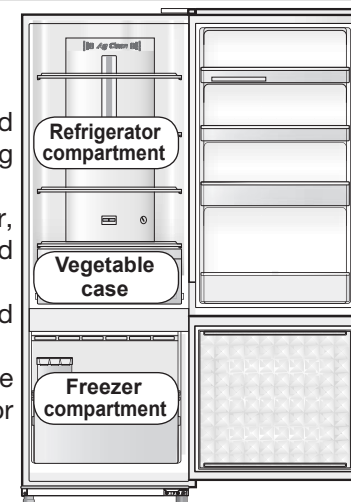

#### Where to store these different foodstuffs ?

Approx.

0°C~5°C

Refrigerator compartment

For regular storage of food and drinks or temporary storage of these to be served soon.



Approx.

3°C~8°C

Vegetable case

A rather high humidity keep fruits and vegetables fresh and juicy.



Approx.

-23°C~-18°C

Freezer compartment

For storage of frozen or dried foods.



- When set to "2" (Med), the temperature may vary slightly depending on the usage conditions.



# Operation

## To use all features

### Using Tips

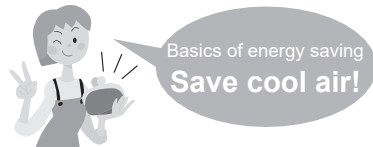

#### Store warm food and drinks after they have cooled.

Otherwise, they will not only raise the interior temperature, but also affect the freshness of other foods.

#### When condensation occurs.

■ The humidity in the vegetable case is high and condensation may occur. Just wipe off the water drops.

#### Do not put food in the refrigerator when it is not necessary.

■ A cold dark place will suffice!



It is not necessary to store uncut onions, potatoes, etc. in the refrigerator (except during the summer).

■ Cool just before you eat!



If uncut tropical fruits are cooled down excessively, they may be discolored or their vitamin contents may decrease.

#### Storage using tightly sealed containers is recommended!

To prevent the interior from being discolored!



To prevent odors from spreading!



• Cut citrus fruits

• Garlicky or other strong smelling vegetables (→ The plastic will be discolored white.) (→ Odors will spread to other nearby food.)

#### Do not stuff food into the compartments.

That may interfere with the cold air flow. Provide sufficient space between foods.



#### Do not block the cold air outlet with food items!

If cool air does not spread into every corner of compartments, then the interior will not be sufficiently cooled and more electricity will be consumed.



(Air outlet)

## Freezer Compartment

### Making ice

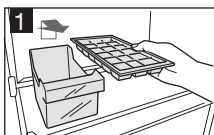

**1 Take out the ice tray**  
Take out the ice tray

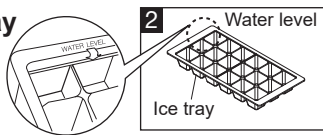

**2 Fill with water**  
Fill water up to the "WATER LEVEL" line

# 序言

## 使用注意事項

### 使用時...



- 請勿將溫熱/炙熱的食物置於雪櫃內。溫熱的食物及飲品可在自然冷卻之後再放入雪櫃。
- 為避免雪櫃內滴水及浪費電，請勿頻繁打開雪櫃或長期打開雪櫃門。

### 打算長時間不使用雪櫃...



- 請拔下雪櫃的插頭，並去除雪櫃中的所有食物。
- 擦去所有水分並打開雪櫃門，以保持其乾燥。

本電器適用於家用及類似應用，如

- 商店寫字樓及其他工作環境中的員工廚房區域；
- 農舍及酒店、汽車旅館及其他居住型環境中的客戶；
- 床及早餐型環境；
- 餐飲及類似非零售應用。

## 安裝

(本產品使用前。)

### 安裝

請勿將本機安裝在以下位置：

- 受熱及陽光直射的地方（冷卻功率會降低，浪費電力。）
- 通風不良，濕度大的場所（可能生鏽並引起漏電。）
- 表面不穩定及傾斜的地點  
→ 在地毯、墊或乙烯基地板上，放一托盤於雪櫃下方。
- 電源插頭無法輕易清潔的位置（積聚的灰塵可能引發火災。）

內部冷卻過程中不應打開雪櫃門。

內部充分冷卻前，不應開門。（流入內部的暖氣會阻礙冷卻功能。）



請等到內部冷卻。

- 內部冷卻可能需大約四小時。
- 內部冷卻並達到平衡可能需24小時或更長時間。

雪櫃周圍是否已預留散熱空間？

雪櫃背面預留10厘米或以上的空間

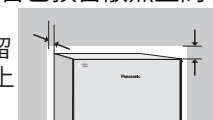

雪櫃上方預留30厘米或以上的空間

左右各預留5厘米或以上的空間

是否已採取措施防止地震導致的傾翻？

固定雪櫃。

旋轉可調節櫃腳（右側），直至其觸及地面以穩定雪櫃。

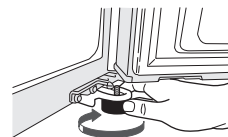

為防止雪櫃傾翻，請使用皮帶等工具進行固定。

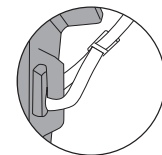

## 序言

### 安全注意事項



- 若您聞到燒焦的氣味，請拔下電源插頭。
- 若發現冷卻氣體洩漏，請對廚房進行通風。
- 如果製冷劑迴路損壞，請勿使用任何電附近的電器或消防設備，並打開所有窗戶以提供良好的通風。也請聯繫您當地的維修代理跟進。
- 雪櫃內LED燈。
- 雪櫃內LED燈專為本雪櫃設計，單獨更換將無法正常運作。若您需要更換，請聯絡經銷商或授權服務代理商。



- 本機不適合體力、感觀或精神狀況不佳之人士（包括兒童）或缺乏經驗或知識之人士使用，除非此等人士的安全負責人已就電器使用給予了監督或說明。
- 應小心看管兒童，不要讓兒童將本機當作玩具。

## 注意

### 儲存食物時...



- 為避免受傷，請勿冷藏玻璃瓶罐。（玻璃瓶罐可能會因瓶內液體冷藏脹大而破裂，令您受傷。）
- 手濕時切勿觸摸冷凍的食物或容器（特別是金屬容器）。
- 切勿食用有異味或變色的食物。腐壞的食物可能會引發疾病。
- 切勿對玻璃托盤施加較大的衝擊力。（否則這些玻璃托盤可能會破碎您可能因此受傷）



- 食物容器必須觸及門架的底部。
- 食物不得突出層架外。

### 開/關雪櫃門時...



- 當有人在雪櫃附近時，請勿打開雪櫃門。
- 注意雪櫃門之間的空隙。關門時可能夾住您的手。
- 請勿握住抽屜的頂部推入抽。
- 注意不要將腳放在下層抽屜的下方。

### 清潔時...



- 切勿將手或腳伸入雪櫃底部的下方。
- 移除蒸發托盤中的水時，請小心盤中的高熱銅管。
- 請勿使用化學物質或液體清潔雪櫃。此等物品可能會損壞及腐蝕雪櫃表面。

### 移動或搬運雪櫃時...



- 切勿打橫搬運雪櫃。打橫放置雪櫃可能會損壞管道。如發現有任何損壞，請勿觸摸雪櫃，避免使用明火，讓房間通風，並立即聯絡服務代理商。



- 表面容易受損的地面應使用防護罩等。
- 搬運雪櫃時，請握住雪櫃的搬運手柄。



## Operation

### To use all features

#### Freezer Compartment

##### Making ice

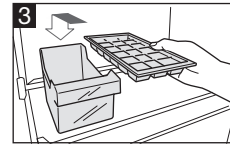

**Making ice**  
Place ice tray inside freezer, wait until ice is made.

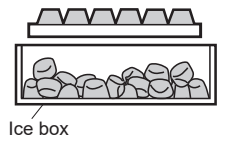
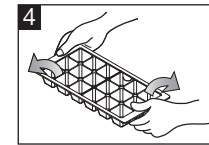

##### To remove ice cubes

Twist the ice tray in opposite directions.  
(Pour out the ice cubes into the ice box.)

#### Refrigerator Compartment

##### The position of the second tray from the top can be changed.

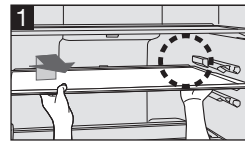

Lift up the back of the tray and pull it forward.

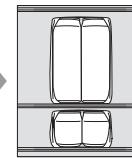
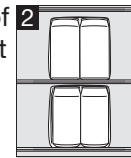

Insert the tray in the desired position by reversing the steps.

##### Request

- Glass shelves are heavy.  
Please handle them carefully so that they do not fall and cause any damage or injury.

## Appendix

### Cleaning, removing and re-installing

Before cleaning or conducting maintenance, be absolutely sure to disconnect the power plug from the power outlet. Do not connect or disconnect the power plug with wet hands. When the plug is disconnected, leave it for 7 minutes before plugging again. If not, the compressor may not work.

#### Cleaning

##### Clean the refrigerator immediately after it is stained!.

Wipe off stains on the interior surfaces quickly before they harden. In particular, cooking oil may cause plastic to crack and citrus juice may cause the refrigerator to become discolored. When stains cannot be removed easily, wipe them with a cloth lightly soaked in neutral kitchen detergent. Then, wipe with a cloth lightly dipped in water.



##### Clean the detachable items occasionally...

Once a week for the ice tray. As a guide, remove the trays, door shelves, etc. and wash them by immersing them in lukewarm water every three months.



## Appendix

### Clean the door gasket at least once a month.

Clean by wiping with a soft damp cloth. petroleum gel has been applied to the door gasket on the hinge side of the unit, be careful not to wipe this off.

Point where petroleum gel was applied.

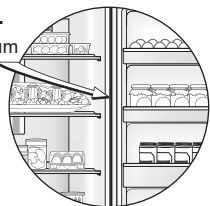

#### Notices

The “door gasket” is replaceable by an authorised service agent. If the door gasket comes off while cleaning, it can be pushed back into the groove.

#### Requests

Do not use the following items for cleaning. (Otherwise, the surface will be scratched.)

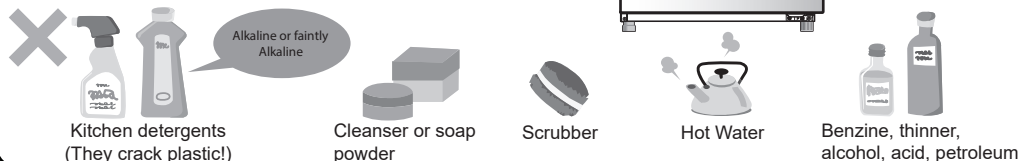

Rub the control panels with a dry cloth.  
Rub the door surface with a soft damp cloth.

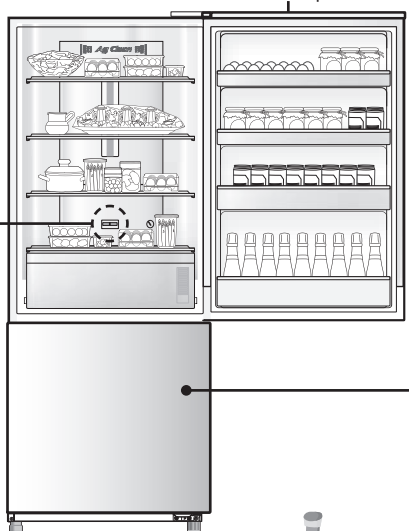

### Door Shelf

Once every 3 months

#### ■ Removing



Hold the selves at bottom left and right side then slowly lift up until it is released.

#### ■ Attaching



Set each shelf horizontally, with the mark [PS] on the right, and push it down until properly locked.

### PC Glass tray

Once every 3 months

#### ■ Removing

- ① Lift up the back of the tray and pull it outward. Once the protrusions of the tray are unhooked from the rails and remove it.

#### ■ Attaching

- ② Push the tray until it reached the end lock.

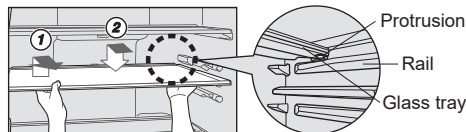

#### Attention

- When removing the tray above the crisper, please pull out the crisper first and then follow to removing the tray as above details.
- In case of attaching the tray and it does not lock, make sure that you did not attach it the wrong tray.
- Trays are made of glass and heavy. Please handle them with care so that they do not fall and cause any damage or injury. For attaching trays, hold them with the protrusion side down and firmly insert.

## 序言

### 安全注意事項

為防止火災, 觸電,  
爆炸, 受傷等



在緊急情況下...



- 必須只能由受過適當培訓的維修工人在車間進行維修工作。



- 請勿將裝有易燃氣體及化學物質的噴霧瓶罐等易爆物品或科學標本置於雪櫃之內。



### 警告



- 請勿在雪櫃內使用電器 (如除臭器)。製冷劑洩漏可能因電氣接點的火花而著火, 並可能導致爆炸。
- 請勿在本機的食物儲藏室內使用電器, 除非是製造商建議的類型。



- 請勿使用機械裝置或其他方式加速解凍過程, 製造商建議的方式除外。
- 請勿自行拆解, 維修或改裝雪櫃。若要維修雪櫃, 請路詢您的經銷商或授權服務中心。

在雪櫃上...



- 請勿在雪櫃頂部放置任何物品。否則, 物品可能會因振動而跌落。

安裝時...



- 切勿將本產品安裝在容易接觸到水的地方。
- 如果將本產品安裝在濕度或水氣大的地方, 請提供接地連接或安裝接地故障斷路器。(請聯絡經銷商。)
- 切勿阻塞雪櫃的通風口或雪櫃周圍的空間。製冷劑洩漏可能導致火災及爆炸。
- 請保持本機外殼中或內置結構中的通風孔不被阻塞。



- 為確保安全, 應檢查室內是否已正確安裝接地連接系統。

使用時...



- 請勿讓兒童攀在或坐在雪櫃門上玩耍, 雪櫃可能會因此翻倒並導致意外。
- 請勿用水沖洗雪櫃機身或內部, 否則會損壞電力絕緣體, 並可能導致觸電或火災。
- 請勿讓任何尖銳物體接觸到冰箱後面和內部的製冷系統。易燃製冷劑可能會著火並導致爆炸。
- 請勿觸摸壓縮機或管道, 此區域溫度極高, 會有發生燙傷的危險。
- 危險請勿在雪櫃附近噴灑可燃性化學物品。



## 序言

### 安全注意事項



#### 警告

此措辭表示可能導致死亡或嚴重受傷。



此標誌代表禁止操作



此標誌代表必需操作



此標誌代表請勿拆卸



#### 注意

此措辭表示可能導致人身傷害或財產損失



iso-butane

異丁烷  
火災風險/易燃物品



#### 警告

### 電源插頭及電源線...



- 請定期用乾布擦拭電源插頭。(當灰塵在持續工作的雪櫃插頭上積聚時, 會由於濕氣降低絕緣功效, 並可能引發火災。)
- 完全插入符合雪櫃額定電流及額定電壓的牆上電源插座。
- 僅連接到供雪櫃專用的牆上電源插座。避免將其他電器連接到同一牆上電源插座上。在插入之前, 請完全展開電源線。
- 清潔雪櫃時, 請拔下雪櫃的電源插頭。
- 如果電源線損壞, 必須由服務代理商或相關的合格人員進行更換以防發生危險。
- 請確保至少10 cm的空隙, 以便通風並防止電源線受損。

### 電源插頭及電源線...



- 請勿讓電源線受損。
- 請勿用濕手插拔牆上電源插座上的電源插頭。
- 放置本電器時, 請確保電源線未被卡住或損壞。
- 請勿於電器後部放置多個便攜式插座或便攜式電源。

### 回收產品時...



- 在回收利用雪櫃之前, 請拆除所有雪櫃門上的密封墊, 以防止兒童被關在裡面。
- 如果雪櫃被搬般遷到其他地點以及被運。到回收廠, 必須將使用說明書轉交給任何可能使用或處理雪櫃的人士。
- 本雪櫃採用環戊烷作為絕緣體, 而製冷劑含有易燃氣體。在棄置本機時, 請採用妥善方法棄置, 請勿焚燒。
- 務必在雪櫃的生命週期內保存好上述警告標籤。

## Appendix

### Vegetable case

Once every 3 months

#### ■ Removing

- ① Pull the case unit forward until it reaches the end of the stopper.
- ② Lift the front of the case unit slightly and remove completely.

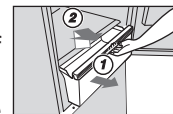

#### ■ Attaching

- ① Insert the case unit into the supports.
- ② Raise the case unit up slightly and push forward until the end is reached.

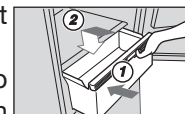

#### Notices

- To keep vegetable and fruit and to maintain its vitamins, please push until it locks properly after use or clean the vegetable case.

### Troubleshooting

In these cases ?	Check here.
The refrigerator does not operate.	<ul style="list-style-type: none"><li>Check the plug and wall socket are in good condition.</li><li>Check if there is any problem with the mains fuse or house wiring.</li><li>Check by unplugging for 7 minutes and plugging back in.</li></ul>
The refrigerator does not cool enough.	<ul style="list-style-type: none"><li>Check to be sure that the control panel is display at proper position (P.7)</li><li>Check to ensure that the refrigerator is not overloaded with foodstuffs or that hot food have been placed in the refrigerator.</li><li>Is the refrigerator exposed to direct sunlight or a heat source?</li><li>Is the refrigerator door completely closed?</li><li>Is the refrigerator door opened frequently?</li></ul>
Vapor generated inside and outside the cabinet / surface of door.	<ul style="list-style-type: none"><li>Condensation may appear on the surface of the cabinet when humidity is high or air circulation around the unit is poor.</li><li>If there is condensation inside, check if the door is completely closed.</li><li>Is the refrigerator frequently opened or left open for long time?</li><li>Have any hot foodstuffs been placed inside the refrigerator?</li></ul>
The refrigerator generates noise.	<ul style="list-style-type: none"><li>Check if the refrigerator is located on a stable, level floor and is installed correctly. Use the adjuster bolt if required to level the refrigerator. (P.6)</li><li>Check if there is any object in contact with the refrigerator.</li><li>Cracking sound within caused by the parts adjusting temperature which is normal.</li><li>After installation, the refrigerator may make loud noise. The noise will be less when the refrigerator has been cooled.</li></ul>
Food becomes frozen	<ul style="list-style-type: none"><li>Was the food placed near the cold air duct?</li><li>If the temperature control has been set to "3" (Max) try adjusting the temperature control to the "1" (Min) setting.</li></ul>

## Appendix

### Specifications

Model No.		NR-BT269
Freezer Star Rating		✱✱✱✱
Capacity (L)	Total	263/221
Gross / Storage (IEC 62552)	Freezer	67/42
	Refrigerator	196/179
Outside Dimensions Width x Depth x Height (mm)		550 x 600 x 1580
Refrigerant Type		R600a
Net Weight (kg / lb)		46/101
Cooling System		Non-frost cooling.
Rated Voltage (V) Rated Frequency (Hz)		Refer to the rating label attached inside of the cabinet.

# Panasonic®

## 使用說明書

雪櫃  
(家用型)

型號

NR-BT269

ECONAVI  
INVERTER



英語.....	2
中文.....	15
目錄.....	

序言.....	
安全注意事項.....	16
安裝.....	19
操作.....	20
部件識別.....	21
使用全部功能.....	21
- 控制面板.....	21
- ECONAVI操作.....	21
- 食物儲存.....	22
- 使用提示.....	23
- 急凍室.....	23
- 冷藏室.....	24
附錄.....	
清洗、拆卸及重新安裝.....	24
疑難排解.....	26
技術規格.....	27



感謝您購買Panasonic雪櫃。

• 使用本雪櫃前，請詳細閱讀說明書。

請特別留意「安全注意事項」（第16及第19頁）以確保安全使用。

• 請確保保用証中的購買日期及零售商名稱蓋有印章，請將保用証與使用說明書一起妥善保存。