

English.....	3
中文	19

Panasonic®

Operating Instructions (Household use) Hair Dryer

Model No. EH-NA0K

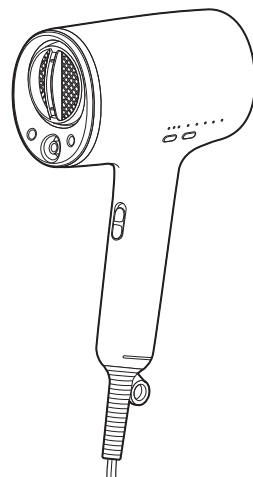

nanoe™
MOISTURE+

Operating Instructions (Household use) Hair Dryer Model No. EH-NA0K

Contents

Safety precautions.....	4	How to use the hair dryer	10
Parts identification	7	Maintenance of the hair dryer	15
About nanoe™ MOISTURE+ and mineral.....	9	Troubleshooting	17
		Specifications	18

Thank you for purchasing this Panasonic product.

Before operating this unit, please read these instructions completely and save them for future use.

- nanoe™ is a trademark of Panasonic Holdings Corporation.
- nanoe™ particles are nano-sized electrostatic atomized water particles.

Safety precautions

Make sure to follow these instructions

To prevent accidents, injuries or damage to property, please follow the instructions below.



WARNING

Indicates potential hazard that could result in serious injury or death.



CAUTION

Indicates potential hazard that could result in minor injury or property damage.

Some parts of the safety precaution illustrations differ from the actual product.



WARNING

► Plug and Cord

- Do not use with the cord bundled.
- Do not damage the cord or plug.
Do not deface, modify, forcefully bend or pull the cord or plug. Also, do not place anything heavy on, twist or pinch the cord.
- Do not use when the plug or cord is damaged or hot.
- Do not wrap the cord tightly around the main body when storing.
- Do not store or use the cord in a twisted state.
- Disconnect the plug by holding onto it instead of pulling on the cord.
- Regularly clean the plug to prevent dust from accumulating.
- Always turn off the power switch and disconnect the plug from the household outlet after use.
- Insert the plug into the household outlet directly:
Do not use with an extension cord.
- Fully insert the plug into a household outlet. Never use the appliance if the plug fits loosely.
- Always ensure the appliance is operated on an electric power source matched to the rated voltage indicated on the appliance.
- When the appliance is used in a bathroom, unplug it after use since the proximity of water presents a hazard even when the appliance is switched off.
- For additional protection, the installation of a residual current device (RCD) having a rated residual operating current not exceeding 30 mA is advisable in the electrical circuit supplying the bathroom. Ask your installer for advice.



WARNING

- If the supply cord is damaged, it must be replaced by the manufacturer, its service agent (described in the warranty), or similarly qualified persons in order to avoid a hazard.

► **In case of an abnormality or malfunction**

- Immediately stop using and remove the plug if there is any abnormality or malfunction.

<Abnormality or malfunction cases>

- Air is not emitted
- Unit stops sporadically
- Interior becomes red hot and smoke is emitted
- The appliance is damaged or deformed, or strange noise is emitted.

Immediately request inspection or repair at an authorized service center.

► **Maintenance**

- When you see sparks around the air outlet while using the hot air setting, stop use and remove the lint on the air outlet and air inlet.

► **This appliance**

- Do not block or insert hair pins or other foreign objects into the air inlet, air outlet, nanoe™ outlet or mineral ion outlet.
- Do not leave the product with power switch on.
- Do not keep within the reach of infants or young children. Do not let them use the appliance.
- Do not use in proximity of flammable materials (such as alcohol, benzine, thinner, spray, hair care product, nail polish remover).

- Never modify, disassemble, or repair.
 - Doing so may cause ignition or injury due to abnormal operation.
- Contact an authorized service center for repair.
- Do not handle any part of the plug or appliance with wet hands.
- This appliance is not designed for commercial use, and is not intended for use without appropriate maintenance.
- Do not immerse the appliance in water.
- Do not use or store the appliance near water.
- Do not use or store the appliance near bathtubs, showers, basins or other vessels containing water.



This symbol with prohibition sign in red on the appliance means "Do not use this appliance near water".

- If you feel pain or abnormality on your skin or other part of your body, immediately stop using this product.
- This appliance is not intended for use by persons (including children) with reduced physical, sensory or mental capabilities, or lack of experience and knowledge, unless they have been given supervision or instruction concerning use of the appliance by a person responsible for their safety. Children should be supervised to ensure that they do not play with the appliance.

CAUTION

► To protect your hair

- Do not use with the air inlet damaged.
- Be sure to keep a distance of over 3 cm between the air outlet and your hair.
- Be sure to keep your hair at least 10 cm away from the air inlet to avoid hair getting tangled.

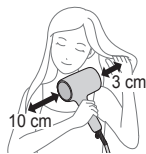

► Note the following precautions

- Do not drop or subject to shock.
- Do not use the appliance for any other purpose than drying hair.
- Do not use on children under 6 years old.
- Do not touch the air outlet, air boost nozzle, night cap nozzle, set nozzle and diffuser which will become very hot.

► Notes

- This hair dryer is equipped with an automatic overheating protective device. If the hair dryer overheats, it will switch to Cold Air mode. Switch off the hair dryer and unplug it from the household outlet. Allow it to cool down for a few minutes before using it again. Check that no fluff, hair etc. is in the air inlets and outlets before switching it on again.
- You may notice a characteristic odor when using this hair dryer. This is the characteristic odor of nanoe™ and mineral ions, or ozone, and is not harmful to the human body.

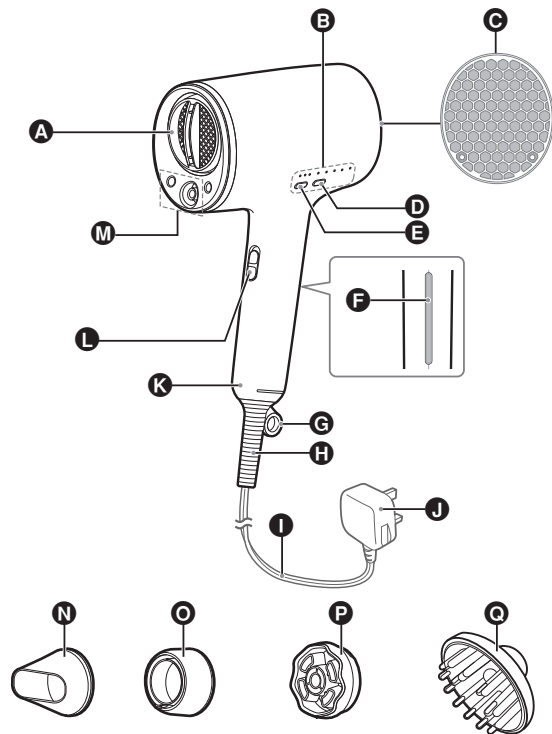

- A** Air outlet
- B** Quick-dry nozzle
- C** Mode indicator
- D** Air inlet
- E** Mode switching button
- F** Airflow switching button
- G** Ion charge plus panel
- H** Ring for hanging
- I** Bushing
- J** Cord
- K** Plug
- L** Handle
- M** Power switch [I/O]
- N** nanoe™ MOISTURE+ and mineral outlet
- O** Set nozzle
- P** Air boost nozzle
- Q** Night cap nozzle
- R** Diffuser

How to attach

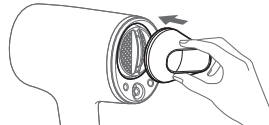

Place the nozzle to the air outlet and firmly insert it into position until locked.

(The illustrations above show the set nozzle.)

How to remove

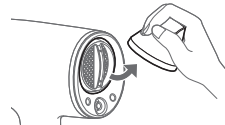

Twist and pull up the nozzle away from the air outlet.

Nozzles

To dry quickly

► Quick-dry nozzle

The nozzle is built into the main body, so it can be used as is without any additional setup.

► Air boost nozzle

It is recommended for those with thick hair or for those who find it difficult to dry the roots of their hair.

To make it easier to dry your hair evenly

► Night cap nozzle

Please use it when the hair is about 70 % dry (with the inside of the hair still slightly damp). Use it while loosening your hair to ensure an even distribution of airflow.

Tips for attaching the nozzle

Align the triangle mark on the nozzle with the groove on the main body, then push it in firmly.



To style your hair

► Set nozzle

For easy styling and blow drying of hair, attach the set nozzle to the hair dryer. Set nozzle helps to direct the airflow onto a specific area of the hair

► Diffuser

For creating full-bodied hair with lots of volume and styling.

Control indicator and mode explanation

When the power switch is turned on, the dryer will start at the fast airflow setting / Hot Air mode.

- On all modes, an airflow enriched with nanoe™ MOISTURE+ and minerals will be provided.

Control Indicator

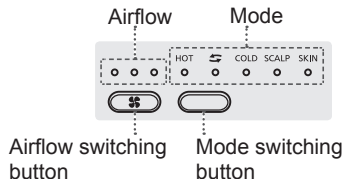

Airflow control

To change the airflow, press the airflow switching button.



Mode control

To change the mode, press the mode switching button.



Mode explanation

Air temperature varies in each mode. Select your desired temperature mode.

Hot Air mode [HOT]

Air temperature is automatically controlled based on the actual room temperature.

Hot/Cold Alternating mode [↔] < Airflow is [Fast] or [Medium] >

Automatically alternate between hot and cold air. It gives you a sleek and shiny finish.

Hair Tip Care mode [↔] < Airflow is [Gentle] >

Automatically alternate between hot and cold air. Intensive care is provided with a gentle airflow that prevents the hair ends from separating easily.

Cold Air mode [COLD]

Finishing with cold air helps keep your hair style in place longer.

Scalp Care mode [SCALP]

Dry your hair comfortably with the airflow of the temperature around 60 °C, which is kind to your skin (scalp).

Skin Care mode [SKIN]

About 1 minute face blowing will help keep your skin moisturized.

It is recommended for skin that is prone to dryness after taking a bath.

- When selecting [SKIN] at the [Fast] or [Medium] setting, the airflow will change to [Gentle]. To return to previous airflow, press the airflow switching button.
- When pressing the airflow switching button during the Skin Care mode, the airflow lamp will blink twice, while the airflow won't change.

About nanoe™ MOISTURE+ and mineral

nanoe™ MOISTURE+ and mineral effect

Controls waviness by balancing hair moisture content, making hair glossy and silky smooth to the touch. Makes hair strong against damage from brushing etc., and leads to beautiful hair.

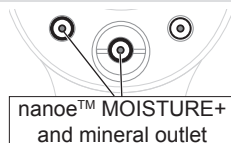

What is nanoe™ MOISTURE+, mineral?

nanoe™ MOISTURE+

nanoe™ MOISTURE+ are nanoe™ ion particles wrapped in water with increased moisture which makes them highly penetrative into hair.

nanoe™ MOISTURE+ are generated by collecting the available moisture in the air, so depending on the usage environment, nanoe™ MOISTURE+ may not be generated. In environments of low temperature and low humidity, moisture in the air becomes difficult to collect. When this occurs, negative ions are generated.

Mineral

“Mineral” means mineral ions generated by the discharge unit containing the zinc electrode.

nanoe™ MOISTURE+ and Mineral are invisible to the human eye.

Ion charge plus

Hair is negatively charged when nanoe™ MOISTURE+ and mineral ions are continuously applied.

Negatively charged hair repulses nanoe™ MOISTURE+ and mineral ions, making it hard for nanoe™ MOISTURE+ and mineral ions to be applied to the hair.

When this occurs, simply by holding the ion charge plus panel together with the handle, the negative charge accumulated on hair is released.

By doing this, nanoe™ MOISTURE+ and mineral ions can continue to penetrate the hair, supplying moisture and moisturizing the hair thoroughly right up to the tip.

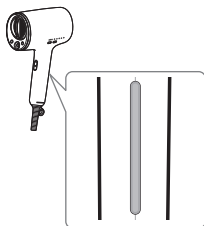

How to use the hair dryer

Preparation

- 1** Use a towel to partially dry your hair.
- 2** Then brush or comb your fingers to remove tangles.
- 3** Plug into the household outlet.

Dry your hair

- 1** Turn the power switch on. Press the airflow switching button and select the [Fast] or [Medium] setting.

- Select [I] with the power switch.
- When turning the power switch on, it may pause a moment before the hot air will come out.

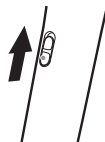

- 2** Direct warm air throughout your hair.

- Your hair will dry quickly if you direct the warm air towards the roots.



3 When the hair is about 90 % dry, use the Hot/Cold Alternating mode to finish it well, making the hair shiny.

- Select [↔] with the mode switching button.



In order to thoroughly apply hot and cold air, part your hair to the left and right to dry it.

1. Apply the Hot/Cold Alternating mode while running your fingers through your hair from the inside. (One side)
2. Apply the Hot/Cold Alternating mode while running your fingers through your hair from the top of your head to the tip of your hair. (One side)
3. Also perform step 1 and 2 on the opposite side.



If you are concerned about damaged ends, use Hair Tip Care mode.

1. Select [Gentle] with the airflow switching button and select [↔] with the mode switching button.
2. While using your fingers to section your hair, blow-dry the inside and outside of your hair to the ends.
3. Perform Step 2 to the opposite side.



4 Turn the power switch off.

5 Remove the plug from the household outlet.

- When drying is complete, finish with a brush or your fingers.
- After the hair dryer has cooled down sufficiently, keep it in a place with low humidity.

To dry your skin (scalp) gently - Scalp Care mode

Do this after drying your hair by about 70% following procedure 2 on P.10

1 Select [SCALP] with the mode switching button.

2 Lift your hair by hand and dry your scalp.

- You may feel cold depending on the ambient temperature. In this case, move the appliance further away from your scalp on [HOT] and apply air.

3 Select [HOT] with the mode switching button and dry your hair overall.



To moisturize your skin - Skin Care mode

Do this after drying your hair

1 Select [SKIN] with the mode switching button.

- The airflow settings will automatically adjust to the [Gentle].



2 Place the air outlet at a distance of about 20 cm from your chin and apply air for about 1 minute, moving the appliance to the left and right.

- Use with your eyes closed.
- Perform skin care using lotion or milky lotion, in the same way and timing as normal.



To make it easier to dry your hair evenly

Starting from the point where your hair is about 70% dry in procedure 2 on P.10, continue until your hair is completely dry.

1. Attach the night cap nozzle.
 2. Select [HOT] with the mode switching button, then apply hot air while running your hand through the hair from the inside.
 3. Direct the hot air from the top of the head to the ends of the hair by running your hand through it.
 4. Perform step 2 and 3 on the opposite side.
- If using scalp mode, use it before using the night cap nozzle.



To set your hair

1. Dampen the area of your hair you want to set with water etc.
2. Select [Gentle] with the airflow switching mode.
3. Select [HOT] with the mode switching button and apply hot air.



To make your hair setting last longer

Apply cold air to the area of your hair you want to set after applying hot air.

To increase hair volume

Lift the base of your hair and apply the hot air from the bottom to the top.

For top



For inner hair



To decrease hair volume

Run your hand through your hair in the same direction as the hair flow, and apply hot air from the top to bottom.



To define the curls and waves with a diffuser

1. Gently place the tip of your hair on the diffuser.
2. Lift your curls up and down from your scalp whilst they are drying.
3. Repeat all sections.
4. Finally, adjust the overall finished look with your hands.

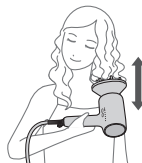

To increase hair volume with a diffuser

Attain volume by moving the diffuser in a circular motion over the scalp. Keep the diffuser held on specific areas of your head for a few seconds to attain volume as you wish. Repeat until your desired look is achieved.



To adjust hair flow with a diffuser

Comb the hair with a diffuser to dry the hair from the roots to the tips while pulling the ends of the hair.



► Notes

- Be careful not to bump the air inlet such as on the corner of a desk.
- Do not look into the air outlet while in use.
- Wave perms may temporarily become easy to stretch when you apply nanoe™ MOISTURE+ and mineral ion to your hair, but return to their original state when you apply water or styling agents.
- Styling and treatment agents etc. can be used. However, if you use sticky substances such as oil, gel or wax, the intended effect of nanoe™ MOISTURE+ and mineral ion may become difficult to achieve.
- Since nanoe™ MOISTURE+ and mineral ions are generated, you might encounter the following.
 - Water droplets may be blown out of the nanoe™ MOISTURE+ outlet during use.
 - You may hear a noise from the nanoe™ MOISTURE+ and mineral outlet or the mineral ion outlet.
 - You may notice a characteristic smell during use.
- Results of nanoe™ MOISTURE+, mineral ions and each mode on hair vary according to the individual, and the following people may find it hard to experience an effect.
 - People with curly hair
 - People with strong wavy hair
 - People with smooth hair that can be easily set
 - People who have had a straightening perm within 3 to 4 months
 - People with extremely short hair

Curly hair	Wavy hair

Maintenance of the hair dryer

Always turn the power switch off and disconnect the plug from the household outlet. (Except when performing maintenance on the air outlet)

Air outlet

Do this about once a month or more

1. Plug into the household outlet.
2. Turn the switch on and select [Gentle], [Medium] or [Fast] with the airflow switching button.
3. Select [COLD] with the mode switching button.
4. While scraping dust and hair jammed in the mesh with a cotton swab, blow them away with air.

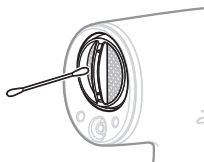

► Notes

- When performing maintenance, do not block the air inlet with your hand.
- Dust may fly out when you use the appliance for the first time after maintenance.
Use the appliance after confirming that dust no longer flies out.
(Do not look into the air outlet.)

Air inlet

Do this about once a month or more

Wipe to clean lint, hair, or other matter from the air inlet with a tissue or toothbrush.



(If dust is attached to the inside, remove it with a vacuum cleaner.)

► Note

- Do not press or rub with your nails or sharp items. Doing so may cause the air inlet to break.

nanoe™ MOISTURE+ and mineral outlet

At least once a month

In order to maintain the generation amount of nanoe™ MOISTURE+ and mineral outlet.

1. Prepare a commercially available new cotton swab (intended for babies) and moisten the tip of the cotton swab with water.
2. Pinch the tip of the cotton swab with clean hands and make the tip thin as shown in the figure to the right.
3. Gently insert the swab in the nanoe™ MOISTURE+ and mineral outlet until it stops (about 1 cm).
4. Turn the cotton swab 2-3 times carefully.

When turned, you may sense the swab getting caught, but this is not an issue.

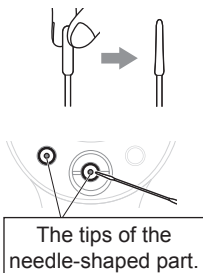

Do not put a cotton swab in any portion other than the part indicated by ○.

Main body

Do this when dirty

To clean the hair dryer (when it is dirty), soak a cloth in the soapy water and squeeze it out firmly, then wipe with the cloth.

► Notes

- Do not use substances such as alcohol, nail polish remover or detergent (hand soap). Doing so may result in malfunction or part cracks or discoloration.
- Do not leave the appliance with hairdressing products or cosmetics on it. Doing so will cause deterioration of the plastic, leading to discoloration and cracks.



Troubleshooting

Problem	Possible cause	Action
The airflow cannot be adjusted despite pressing the airflow switching button, while the airflow lamp will turn on after blinking two times.	▶ Check that the Skin Care mode is selected.	▶ On the Skin Care mode, the airflow settings will automatically adjusted to [Gentle], and the airflow cannot be adjusted by pressing the airflow switching button. (See page 9.)
Sparks can be seen inside the product. - These sparks are caused by protective device (thermostat switch). They are not dangerous.	▶ Lint has accumulated on the air inlet or air outlet.	▶ Remove accumulated lint. (See page 15.)
Hot air repeatedly turns into cold air.	▶ Hair or something is blocking the air inlet.	▶ Do not block the air inlet.
The hot air is abnormally hot.	▶	
The plug is abnormally hot.	▶ The plug does not fit snugly in the outlet being used	▶ Use an outlet in which the plug fits snugly.
	▶ The plug is not firmly inserted into the outlet.	▶ Insert the plug firmly into the outlet.
Sparks are generated inside the nanoe™ MOISTURE+ and mineral outlet	▶ The needle-shaped part located at the back of the nanoe™ MOISTURE+ and mineral outlet is dirty.	▶ Perform maintenance on the nanoe™ MOISTURE+ and mineral outlet. (See page 16.)
A noise (crackling) is heard inside the nanoe™ MOISTURE+ and mineral outlet.	▶	
The temperature of the air is not hot.	▶ This is due to the two sensors detecting the environment and usage and automatically controlling the air temperature. This is not an abnormality.	
There is a peculiar smell.	▶ This is the characteristic odor of nanoe™ MOISTURE+, mineral ions, or ozone, and is not harmful to the human body.	
Water droplets fly out from the nanoe™ MOISTURE+ and mineral outlet	▶ Water droplets occasionally fly out from when generating nanoe™ MOISTURE+; this is not an abnormality.	

If the problems still cannot be solved, contact the store where you purchased the unit or a service center authorised by Panasonic for repair.

Specifications

Power source	Power consumption
220 V~ 50-60 Hz	1 300 W
230 V~ 50-60 Hz	1 450 W
240 V~ 50-60 Hz	1 600 W

When using [HOT] [Fast] at maximum operating power

Accessories	Set nozzle, Air boost nozzle, Night cap nozzle, Diffuser
-------------	---

This product is intended for household use only.

內容

安全須知	20	風筒保養	31
部件名稱	23	疑難排解	33
關於 nanoe™ MOISTURE+ 及礦物質 ..	25	規格	34
如何使用風筒	26		

- nanoe™ 是 Panasonic Holdings Corporation 的商標。
- nanoe™ 微粒是 nano 尺寸的靜電霧化水顆粒。

安全須知

確保遵從以下指引

為了防止意外、受傷或財產受損，請遵從以下指示。



警告

是指或會導致嚴重受傷或死亡的潛在危險。



注意

是指或會導致輕微受傷或財產受損的潛在危險。

安全注意事項圖示的某些部分可能與實際產品不同。

警告

▶ 插頭與電源線

- 切勿在使用時將電源線綑綁在一起。
- 切勿損壞電源線或插頭。切勿損壞、改裝、用力彎曲或拉扯電源線或插頭。此外，切勿將任何重物置於電源線上，扭曲或擠壓電源線。
- 當插頭或電源線損壞或發熱時，切勿使用。
- 儲藏時，切勿將電源線纏繞住本機主體。
- 切勿在扭曲狀態下存放或使用電源線。
- 拔除電源插頭時，請握住插頭，不要拉扯電源線。
- 請定期清潔電源插頭，避免灰塵堆積。
- 使用後，請務必關閉電源開關並從家用插座拔除電源插頭。
- 將電源插頭直接插入家用插座：切勿搭配延長電源線使用。
- 請完全插入電源插頭。如果無法完全插入，切勿使用本產品。
- 請務必確保在符合本產品上指定的額定電壓的電源上操作本產品。
- 若在浴室中使用本產品，使用完畢後請拔下電源插頭，因為即使本產品已經關掉，它在接近水時仍然存在危險。
- 為了保護您的安全，建議您在浴室的供電電路中安裝一個額定漏電動作電流不超過 30 mA 的漏電保護開關 (RCD)。請諮詢安裝人員以獲得建議。



警告

- 如果本機的電源線已經損壞，務必立即停止使用，並送交 Panasonic 直屬服務站進行更換。

► 如出現異常或故障

- 如果出現異常或故障，請立即停止使用並拔除電源插頭。
< 異常或故障情況 >
 - 無法送風
 - 本機出現偶爾停止的現象
 - 內部變成火紅炙熱狀且冒煙
 - 產品受損壞或變形，或發出奇怪的聲音。請立即將產品帶往 Panasonic 直屬服務站，以要求檢查或維修。

► 保養

- 使用熱風設定時，如果您看到出風口處出現火花，請停止使用並清除出風口與入風口處的堵塞物。

► 產品

- 切勿堵塞或插入髮夾或其他異物到入風口、出風口、nanoe™ 出風口或礦物質離子出口。
- 切勿將已開啟電源的產品置之不顧。
- 請勿置於幼童或兒童可觸及的地方。請勿讓兒童使用本產品。
- 切勿在易燃物質（例如，酒精、揮發油、稀釋劑、噴霧、護髮產品、洗甲水）附近使用。

- 切勿改裝、拆卸或維修本產品。
 - 否則可能會導致著火，或因異常操作而造成傷害。請聯絡授權維修中心進行維修。
- 請勿在雙手潮濕的情況下處理插頭或電器的任何部份。
- 本產品並非設計用於商業用途，請在適當的保養下使用。
- 切勿將本產品浸入水中。
- 請勿在靠近水的位置使用或存放本產品。
- 請勿在浴缸、淋浴設備、洗臉盆或其他盛水容器附近使用或存放本產品。



本產品上帶有紅色禁止標誌、表示「切勿在近水處使用本產品」。

- 如果您感到皮膚或身體其他部位疼痛或出現異常，請立即停止使用本產品。
- 本產品不宜供肢體、感官或精神上有障礙、或缺乏經驗及知識等人士（包括兒童）使用，必須有監護人從旁監督，並指導使用本產品，且能承擔使用者安全的責任。請監督兒童，避免他們把玩本產品。

⚠ 注意

► 保護您的頭髮

- 當入風口損壞時、切勿使用。
- 確保出風口與頭髮之間保持3 cm以上的距離。
- 確保您的頭髮距離入風口至少10 cm，以避免頭髮被卷入風口。



► 請注意以下注意事項

- 請避免本產品掉落或受到撞擊。
- 除了吹乾頭髮以外，請勿將本產品用於其他目的。
- 請勿用於六歲以下的兒童。
- 切勿接觸出風口、強力風咀、夜用風咀、造型風咀及風罩，這些部位溫度非常高。

► 注意

- 這款風筒配有自動過熱保護裝置。如風筒出現過熱，將轉為冷風模式。如發生此情況，請關閉風筒並從家用插座拔出電源插頭。讓風筒冷卻數分鐘後再使用。再次開啟前，請檢查入風口及出風口是否有毛髮、灰塵等雜物。
- 使用風筒時可能會聞到一種特別的氣味。這是 nanoe™ 及礦物離子或臭氧的特有氣味，對人體無害。

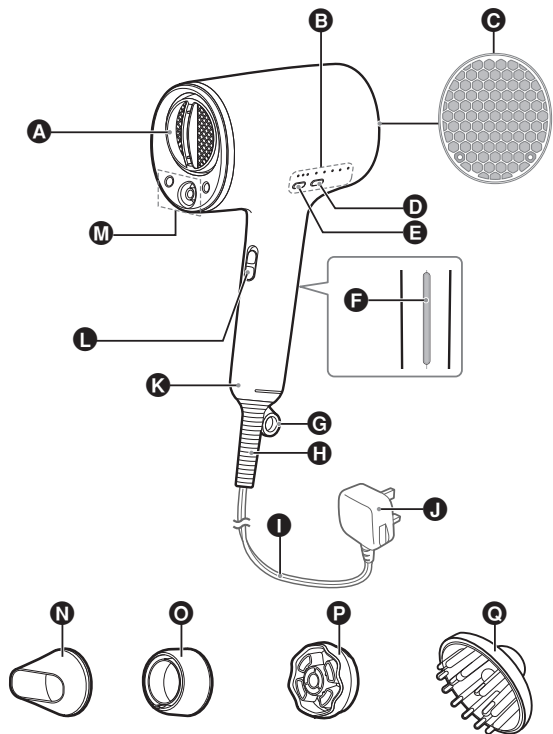

- A 出風口速乾風咀
- B 模式指示燈
- C 入風口
- D 模式切換按鈕
- E 風力切換按鈕
- F 離子電荷+ 面板
- G 掛環
- H 襯套
- I 電源線
- J 插頭
- K 手柄
- L 電源開關 [I/O]
- M nanoe™ MOISTURE+ 及礦物質出口
- N 造型風咀
- O 強力風咀
- P 夜用風咀
- Q 風罩

如何安裝

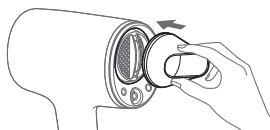

將風咀置於出風口並牢固地插入到位直至鎖定。

如何卸除

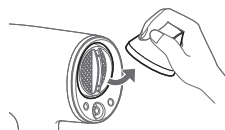

扭轉風咀並將其拉離出風口。

(上圖所示為造型風咀。)

風咀

快速風乾

► 速乾護髮吹嘴

此風咀內置在機身中，因此可以原樣使用，無需任何額外的裝組。

► 強力風咀

建議頭髮濃密的人，或是覺得難以吹乾髮根的人使用。

更均勻地吹乾頭髮

► 夜用風咀

請在頭髮約七成乾時使用（頭髮內側仍然略濕）。在鬆開頭髮時使用，以確保氣流平均分佈。

風咀安裝貼士

將風咀上的三角形標記與機身上的凹槽對齊，然後用力推入。

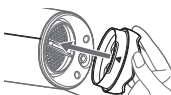

頭髮造型

► 造型風咀

為了方便造型和吹乾頭髮，可於風筒上安裝造型風咀。造型風咀有助將風力集中在頭髮的特定區域。

► 風罩

塑造有大量髮量和造型的髮型。

控制指示燈及模式說明

打開電源開關後，風筒將以快速風力設定/熱風模式啟動。

- 在所有模式下，都會提供富含 nanoe™ MOISTURE+ 及礦物質的風力。

控制指示燈

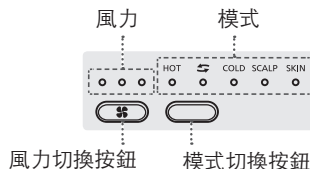

風力控制

若要變更風力，請按風力切換按鈕。



模式控制

若要變更模式，請按模式切換按鈕。



模式說明

每種模式下的風溫各不相同。選擇您所需的溫度模式。

熱風模式 [HOT]

根據實際環境溫度自動調節出風溫度。

熱/冷交替模式 [↔] < 風力為 [快速] 或 [適中] >

自動交替熱風和冷風。

可讓髮絲擁有光滑亮澤的外觀。

髮尾護理模式 [↔] < 風力 [輕柔] >

自動交替熱風和冷風。

透過溫和氣流提供密集均勻保養，令髮尾不易開叉。

冷風模式 [COLD]

用冷風進行整理有助於讓髮型保持更長時間。

頭皮護理模式 [SCALP]

用 60° C 左右的風力舒適地吹乾頭髮，對皮膚（頭皮）來說很溫和。

美肌模式 [SKIN]

吹面部大約 1 分鐘有助於保持皮膚濕潤。

建議沐浴後肌膚容易乾燥的人士使用。

- 在 [快速] 或 [適中] 設定中選擇 [SKIN] 時，風力將變更為 [輕柔]。若要返回之前的風力，請按風力切換按鈕。
- 在美肌模式時按下風量切換按鈕，風量燈將閃爍兩次而風量不會改變。

關於 nanoe™ MOISTURE+ 及礦物質

nanoe™ MOISTURE+ 及礦物質效果

透過平衡頭髮水份來控制捲曲度，使頭髮亮澤柔滑。
使頭髮能夠抵抗梳理等造成的損傷，打造美麗秀髮。



什麼是 nanoe™ MOISTURE+ 及礦物質？

nanoe™ MOISTURE+

nanoe™ MOISTURE+ 包裹在水中增加了水份的 nanoe™ 水離子，能夠提升對頭髮的滲透性。
nanoe™ MOISTURE+ 的產生源自於空氣中的水份，因此，視使用時所處的環境而定，nanoe™ MOISTURE+ 可能不會產生。在低溫和低濕的環境，難以從空氣中收集水份。在這種情況下，則會產生負離子。

礦物質

「礦物質」是指由包含鋅電極的放電單元產生的礦物質離子。

肉眼無法看見 nanoe™ MOISTURE+ 及礦物質。

離子電荷+

當持續使用 nanoe™ MOISTURE+ 及礦物質離子時，頭髮會帶負電。帶負電的頭髮會排斥 nanoe™ MOISTURE+ 及礦物質離子，使 nanoe™ MOISTURE+ 及礦物質離子難以附著在頭髮上。

發生這種情況時，只需將離子電荷+ 面板與手柄握持在一起，頭髮上積累的負電荷就會被釋放。

這樣做，nanoe™ MOISTURE+ 及礦物質離子可以繼續滲透頭髮，提供水分，並徹底滋潤頭髮直至髮尾。

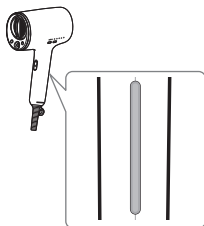

中文

如何使用風筒

準備

- 1 使用毛巾將頭髮部分擦乾。
- 2 然後用手指刷理或梳理以消除纏結。
- 3 插入家用插座。

吹乾捲髮

- 1 打開電源開關。按風力切換按鈕並選擇 [快速] 或 [適中] 設定。
 - 使用電源開關選擇 [I]。
 - 打開電源開關後，可能會停頓一會兒，熱風才會出來。
- 2 將暖風吹遍頭髮。
 - 如果將暖風吹向髮根，頭髮會很快吹乾。



3 當頭髮吹乾 90% 左右時，用冷熱交替模式梳理，使頭髮光澤亮麗。

- 使用模式切換按鈕選擇 [↔]。



為了充分利用熱風和冷風，請將頭髮左右分開吹乾。

1. 使用熱/冷交替模式，同時用手指從內部梳理頭髮。（一側）
2. 使用熱/冷交替模式，同時用手指從頭頂到髮尾梳理頭髮。（一側）
3. 同樣在另一側執行步驟 1 和 2。



如果您擔心髮尾受損，請使用髮尾護理模式。

1. 使用風力切換按鈕選擇 [輕柔]，然後使用模式切換按鈕選擇 [↔]。
2. 用手指將頭髮分開，吹乾頭髮的內側和外側直至髮尾。
3. 對另一側執行步驟 2。



4 關閉電源開關。

5 從家用插座上拔下插頭。

- 吹乾完成後，用梳子或手指進行整理。
- 風筒充分冷卻後，將其放置在濕度較低處。

輕柔吹乾肌膚（頭皮）- 頭皮護理模式

按照第 26 頁步驟 2 所述將頭髮吹乾約 70% 後執行此操作。

1 使用模式切換按鈕選擇 [SCALP]。

2 用手提起頭髮並擦乾頭皮。

- 視乎環境溫度，您可能會感到寒冷。在這種情況下，將本產品遠離頭皮，以 [HOT] 模式使用風力。

3 使用模式切換按鈕選擇 [HOT]，並吹乾整個頭髮。



為肌膚保濕 - 護膚模式

吹乾頭髮後執行此操作

1 使用模式切換按鈕選擇 [SKIN]。

- 風力設定會自動調整為 [輕柔]。

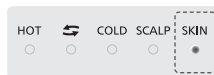

2 將出風口放置在距離下巴約 20 厘米的位置，左右移動本產品，使用風力約 1 分鐘。

- 請閉上眼睛使用。
- 按照與平常一樣的方式和時間，使用化妝水或乳液進行護膚。



更均勻地吹乾頭髮

從第 26 頁第 2 個步驟中頭髮約七成乾的地方開始，直至頭髮乾透為止。

1. 安裝夜用風咀。
 2. 用模式切換按鈕選擇 [HOT]，然後以手從頭髮內側掠過頭髮，同時以熱風吹拂。
 3. 用手將熱風從頭頂引導至髮尾。
 4. 同樣在另一側執行步驟 2 和 3。
- 如要使用頭皮模式，請在使用夜用風咀前使用。



整理頭髮

1. 用水等沾濕您想要定型的頭髮區域。
2. 使用風力切換模式選擇 [輕柔]。
3. 使用模式切換按鈕選擇 [HOT]，然後使用熱風。



讓髮型更持久

使用熱風後，在您想要定型的頭髮區域使用冷風。

增加髮量

提起髮根，從下往上吹熱風。

針對頭頂



針對內部頭髮



減少髮量

用手順沾頭髮垂下的方向梳理頭髮，從上往下吹熱風。



使用風罩對捲髮和波浪造型

1. 輕輕地將髮尾放在風罩上。
2. 在吹乾頭髮的同時，從頭皮上上下下地提起捲髮。
3. 重複所有部分。
4. 最後，用手調整髮型的整體外觀。

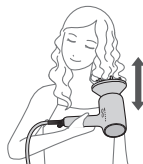

使用風罩增加髮量

在頭皮上方以圓周運動移動風罩，來增加髮量。將風罩保持在頭部特定區域幾秒鐘，以獲得想要的髮量。重複操作，直至達到所需的造型。



使用風罩調整頭髮垂下位置

使用風罩梳理頭髮，從髮根到髮尾吹乾頭髮，同時拉動髮尾。



► 注意

- 注意切勿碰撞入風口，例如桌角。
- 切勿向出風口內看。
- 對頭髮使用 nanoe™ MOISTURE+ 及礦物質離子時，波浪燙髮可能會暫時變得容易拉伸，但在您塗抹水或定型劑時，會恢復到原來的狀態。
- 可以使用定型劑和護髮劑等。然而，如果您使用精油、凝膠或蠟等黏性物質，可能會難以達到 nanoe™ MOISTURE+ 及礦物質離子的預期效果。
- 由於產生 nanoe™ MOISTURE+ 及礦物質離子，可能會出現以下情況。
 - 在使用過程中，水滴可能會從 nanoe™ MOISTURE+ 出口吹出。
 - 您可能會聽到 nanoe™ MOISTURE+ 及礦物質出口或礦物質離子出口發出噪音。
 - 在使用過程中，您可能會聞到特有的氣味。
- nanoe™ MOISTURE+、礦物質離子及每種模式對頭髮的效果因人而異，以下髮型的人群可能很難體驗到效果。
 - 小捲髮人群
 - 大波浪捲髮人群
 - 頭髮順滑、容易定型人群
 - 3 至 4 個月內燙直過頭髮人群
 - 頭髮極短人群

小捲髮	大波浪捲髮

風筒保養

務必關閉電源開關並從家用插座拔出插頭。(保養出風口時除外)

出風口

每月一次或更長時間對風筒進行保養

1. 插入家用插座。
2. 打開開關，使用風力切換按鈕選擇 [輕柔]、[適中] 或 [快速]。
3. 使用模式切換按鈕選擇 [COLD]。
4. 用棉花棒擦拭卡網孔中的灰塵和頭髮，同時吹風將其吹走。

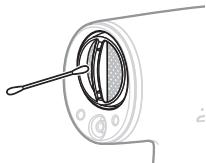

► 注意

- 保養期間，切勿以手或其他物件阻擋入風口。
- 保養後首次使用本產品時，可能會飛出灰塵。確認灰塵不再飛出後使用本產品。(切勿向出風口內看。)

入風口

每月一次或更長時間對風筒進行保養

用衛生紙或牙刷擦拭，清除入風口的棉絮、頭髮或其他東西。



(如果內部有灰塵附著，請用吸塵機將其移除。)

► 注意

- 切勿用您的指甲或尖銳物品按壓或摩擦。否則可能造成入風口破損。

nanoe™ MOISTURE+ 及礦物質出口

每月至少一次

這樣可維持 nanoe™ MOISTURE+ 和礦物負離子出風口的產生量。

1. 準備市售的新棉花棒（嬰兒用），並用水潤濕棉花棒的尖端。
2. 用乾淨的手捏住棉花棒的尖端，使尖端變細，如右圖所示。
3. 輕輕地將棉籤插入 nanoe™ MOISTURE+ 及礦物質出口，直至其停止（約 1 厘米）。
4. 小心地轉動棉花棒 2-3 次。轉動時，您可能會感覺到棉花棒被卡住，但這不是問題。

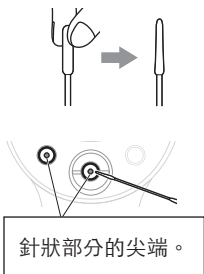

請勿將棉花棒放入除○所示部分以外的任何部分。

機身

髒污時執行此操作

若要清潔本機（當風筒變髒時），請將布浸入肥皂水中並用力擠壓，然後用布擦拭風筒。

► 注意

- 切勿使用酒精、洗甲水或洗滌劑（洗手液）等物質。否則可能導致故障、或是零件出現裂縫或變色。
- 切勿在本產品上留下美髮產品或化妝品。否則會造成導致塑料變質，進而導致變色或出現裂縫。



疑難排解

問題	導致故障原因	措施
按風力切換按鈕時無法調整風力，風力指示燈閃爍兩次後亮起。	▶ 檢查是否選擇了美肌模式。	▶ 在美肌模式下，風力設定會自動調整為[輕柔]，並且按風力切換按鈕時無法調整風力。(參閱第25頁。)
產品內部可能會出現火花。 - 這些火花是由保護裝置(恆溫開關)引起。沒有危險。	▶ 棉絮堆積在入風口或出風口。	▶ 清除堆積的棉絮。(參閱第31頁。)
熱風反復變為冷風。	▶ 頭髮或其他東西堵塞在入風口。	▶ 切勿堵塞入風口。
熱風異常高溫。	▶	
插頭異常高溫。	▶ 插頭無法緊密插入使用的插座	▶ 使用能緊密貼合插頭的插座。
	▶ 插頭未牢固插入插座。	▶ 將插頭牢固地插入插座。
nanoe™ MOISTURE+ 及礦物質出口內部產生火花	▶ 位於 nanoe™ MOISTURE+ 及礦物質出口背面的針狀部分髒污。	▶ 對 nanoe™ MOISTURE+ 及礦物質出口進行保養。(參閱第32頁。)
nanoe™ MOISTURE+ 及礦物質出口內聽到噪音(爆裂聲)。	▶	
風溫並不熱。	▶ 這是由於兩個感應器可偵測四周環境和使用情況，並自動控制出風溫度。這並非異常。	
產生特殊的氣味。	▶ 這是 nanoe™ MOISTURE+、礦物離子或臭氧的特有氣味，對人體無害。	
水滴 nanoe™ MOISTURE+ 及礦物質出口飛出	▶ 產生 nanoe™ MOISTURE+ 時偶爾會有水滴飛出；這並非異常。	

如果仍然無法解決問題，請與您購買本機的商店聯繫，或聯絡 Panasonic 直屬服務站進行維修。

規格

電源	消耗電置
220 V～ 50-60 Hz	1 300 W
230 V～ 50-60 Hz	1 450 W
240 V～ 50-60 Hz	1 600 W

以最大工作功率使用 [HOT] [快速] 時

配件	造型風咀、強力風咀、 夜用風咀、風罩
----	-----------------------

本產品僅供家庭使用。

Panasonic Corporation
<https://www.panasonic.com>
© Panasonic Corporation 2025