



Operating Instructions

WASHER DRYER

Model No . NA-S107F2WBZ
NA-S107F2WBR
NA-S128F2WBZ
NA-S128F2WBR
NA-S086F1WHK

Thank you very much for purchasing Panasonic Washing Machine

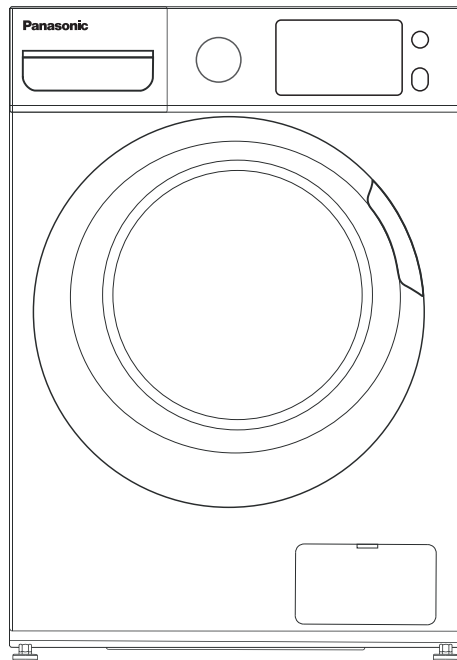

*Picture is for illustration only

Before operating this unit, please completely read these instructions especially the **Safety Precautions and Important Instructions**.



It is essential to read these instructions.

CONTENTS

SAFETY INSTRUCTIONS

| | |
|-----------------------------|---|
| ■ Safety Instructions | 2 |
|-----------------------------|---|

INSTALLATION

| | |
|-----------------------------|---|
| ■ Product Description | 8 |
| ■ Installation | 9 |

OPERATIONS

| | |
|----------------------------------|----|
| ■ Quick Start | 12 |
| ■ Before Each Washing | 13 |
| ■ Detergent Drawer..... | 14 |
| ■ Control Panel | 16 |
| ■ Option..... | 17 |
| ■ Other Functions | 19 |
| ■ Programmes..... | 22 |
| ■ Washing Programmes Table | 23 |

MAINTENANCES

| | |
|---|----|
| ■ Cleaning And Care | 24 |
| ■ Trouble Shooting | 27 |
| ■ Technical Specifications | 28 |
| ■ Installation Instruction of Rat Resistance Panel..... | 30 |

SAFETY INSTRUCTIONS

■ Safety Instructions

For your safety, the information in this manual must be followed to minimize the risk of fire or explosion, electric shock, or to prevent property damage, personal injury or loss of life.

Explanation of the symbols:

Warning!

This combination of symbol and signal word indicates a potentially dangerous situation which may result in death or serious injuries unless it's avoided.

Caution!

This combination of symbol and signal word indicates a potentially dangerous situation which may result in slight or minor injuries or damage to property and the environment.

Note!

This combination of symbol and signal word indicates a potentially dangerous situation which may result in slight or minor injuries.

Warning!

The electric shock!

- If the supply cord is damaged, it must be replaced by the manufacturer, its service agent or similarly qualified persons in order to avoid a hazard.
- The new hose-sets supplied with the appliance are to be used and old hose-sets should not be reused.
- Before any maintenance the device, unplug the appliance from the mains.

SAFETY INSTRUCTIONS

- Always unplug the machine and turn off the water supply after use. The max. inlet water pressure, in pascals. The min. inlet water pressure, in pascals. Standard Water Pressure 0.05MPa-1MPa.
- To ensure your safety, power plug must be inserted into an earthed three-pole socket. Check carefully and make sure that your socket is properly and reliably earthed.
- Make sure that the water and electrical devices must be connected by a qualified technician in accordance with the manufacturer's instructions and local safety regulations.
- Pull out its plug from the power socket before cleaning or maintenance.
- Do not use any socket with rated current less than that of appliance. Never pull out power plug with wet hand.
- Please remember to disconnect water and power supply immediately after the clothes are washed.

Risk to children!

- This appliance is not intended for use by persons (including children) with reduced physical, sensory or mental capabilities, or lack of experience and knowledge, unless they have been given supervision or instruction concerning use of the appliance by a person responsible for their safety.
- Children should be supervised to ensure that they do not play with the appliance.
- Animals and children may climb into the machine. Check the machine before every operation.

SAFETY INSTRUCTIONS

- Glass door may be very hot during the operation. Keep kids and pets far away from the machine during operation.
- Remove all packages and transport bolts before using the appliance. Otherwise, serious damage may result.

Risk of explosion!

- Do not wash or dry articles that have been cleaned in, washed in, soaked in, or dabbed with combustible or explosive substances(such as wax, oil, paint, gasoline, degreasers, dry-cleaning solvents, kerosene, etc.) This may result in fire or explosion.
- The appliance is not to be used if industrial chemicals have been used for cleaning.
- The exhaust air must not be discharged into a flue which is for exhausting fumes from appliances burning gas or other fuels.
- Thoroughly rinse items of washing by hand in advance .

Caution!

Installing the product!

- This appliance is for indoor use only.
- It isn't intended to be built-in using.
- Do not obstruct the openings of the bottom side with carpet, etc.
- The appliance shall not be installed in bathroom or very wet rooms as well as in the rooms with explosive or caustic gases.
- The appliance with single inlet valve can only be connected to the cold water supply. The appliance with double inlet valves should be correctly connected to the

SAFETY INSTRUCTIONS

hot water and cold water supply.

- Plug must be accessible after installation.
- The appliance must not be installed behind a lockable door, a sliding door or a door with a hinge on the opposite side to that of the appliance, in such a way that a full opening of the appliance door is restricted.
This will prevent children from being locked in the drum.
- The appliance shall not be installed at a humid place.
- The household appliance isn't intended to be built-in.
- Remove all packages and transport bolts before using the appliance. Otherwise, serious damage may result.

Risk of damaging appliance!

- The product is only for home use and is only designed for the textiles suitable for machine washing and drying.
- Do not climb up and sit on top cover of the machine.
- Do not lean against machine door.
- Cautions during Handling Machine:
 1. Transport bolts shall be reinstalled to the machine by a specialized person.
 2. The accumulated water shall be drained out of the machine.
 3. Handle the machine carefully. Never hold any protruded part on the machine while lifting. Machine door cannot be used as the handle during the conveyance.
 4. This appliance is heavy. Transport with care.
 5. Hands shall not be inserted into running water extracting tub.
- Please do not close the door with excessive force. If it is difficult to close the door, please check if the clothes are put in or distributed well.
- It is forbidden to wash carpets.
- The lint must not be allowed to accumulate around the appliance.

SAFETY INSTRUCTIONS

Operating the appliance!

- Before washing your laundry for the first time, the product shall be operated in a complete round of washing cycle without laundry inside.
- Flammable and explosive or toxic solvents are forbidden. Gasoline and alcohol etc. shall not be used as detergents. Please only select the detergents suitable for machine washing, especially for drum.
- Make sure that all pockets are emptied. Sharp and rigid items such as coin, brooch, nail, screw or stone etc. may cause serious damages to this machine.
- Please check whether the water inside the drum has been drained before opening its door. Please do not open the door if there is water visible.
- Mind the danger of burning when the product drains hot washing water.
- After the program is completed, please wait for two minutes before opening the door (Some model).
- Never refill the water by hand during washing.
- If it is unavoidable that fabrics which contain vegetable or cooking oil or have been contaminated by hair care products. If placed in a tumble dryer they should first be washed in hot water with extra detergent, this will reduce, but not eliminate, the hazard.
- Adequate ventilation has to be provided to avoid the back flow of gases into the room from appliances burning other fuels, including open fires.
- Do not dry unwashed items in the appliance.
- Items that have been soiled with substances such as cooking oil, acetone, alcohol, petrol, kerosene, spot removers, turpentine, waxes, wax removers and cosmetic oils must not be dried in the appliance even after having been washed.

SAFETY INSTRUCTIONS

- Items such as foam rubber (latex foam), shower caps, waterproof textiles, airtight fabrics, rubber backed articles and clothes or pillows fitted with foam rubber pads should not be dried in the appliance. Such materials may be destroyed and thereby damage the appliance.
- Fabric softeners, or similar products, should be used as specified by the fabric softener instructions.
- The machine which its lid can be opened during water extraction, that it takes 15s or more for complete stop of water extracting chamber tub.
- The final part of a washer dryer cycle occurs without heat (cool down cycle) to ensure that the items are left at a temperature and thus the items will not be damaged.
- Make sure that no objects are left in any of the pockets. Pay particular attention to cigarette lighter and matches. They may cause fire.
- **WARNING:** Never stop the appliance before the end of the drying cycle unless all items are quickly removed and spread out so that the heat is dissipated.

Packaging/Old appliance



This marking indicates that this product should not be disposed with other household wastes throughout the EU. To prevent possible harm to the environment or human health from uncontrolled waste disposal, recycle it responsibly to promote the sustainable reuse of material resources. To return your used device, please use the collection systems or contact the retailer where the product was purchased. They will take this product for environmental safe recycling.

INSTALLATION



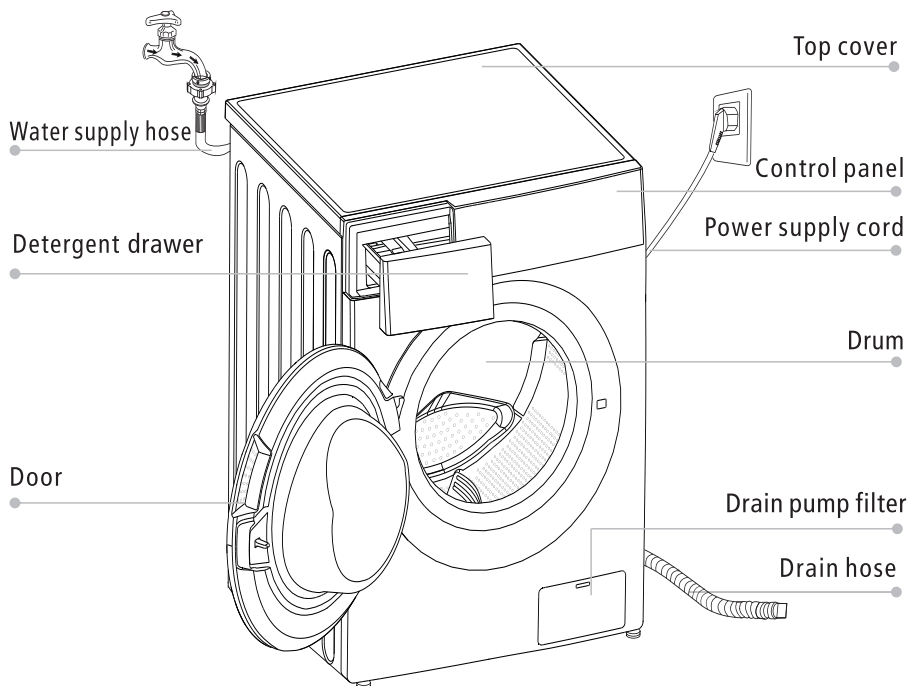

■ Product Description

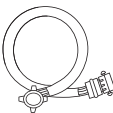

Note!

- The product line chart is for reference only, please refer to real product as standard.

Accessories

| | | | | |
|---|---|---|---|---|
|  |  |  |  |  |
| Transport hole plug | Supply hose cold water | Drain hose support (optional) | Owner's manual | Rat resistance panel sticky tape |

INSTALLATION

■ Installation

Installation area

⚠ Warning!

- Stability is important to prevent the product from wandering!
- Make sure that the product should not stand on the power cord.

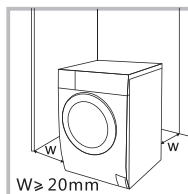

Before installing the machine, the location characterized as follows shall be selected:

1. Rigid, dry, and level surface
2. Avoid direct sunlight
3. Sufficient ventilation
4. Room temperature is above 0 °C
5. Keep far away from the heat resources such as coal or gas.

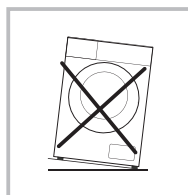

Unpacking the washing machine

⚠ Warning!

- Packaging material (e.g. film , styrofoam) can be dangerous for children.
- There is a risk of suffocation ! Keep all packaging well away from children.

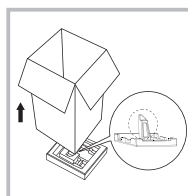

1. Remove the cardboard box and styrofoam packing.
2. Lift the washer dryer and remove the base packing. Make sure the small triangle foam is removed with the bottom one together. If not, lay the unit down with side surface, then remove the small foam from the unit bottom manually.
3. Remove the tape securing the power supply cord and drain hose.
4. Remove the inlet hose from the drum.

Remove transport bolts

⚠ Warning!

- You must remove the transport bolts from the backside before using the product.
- You'll need the transport bolts again if you move the product , so make sure you keep them in a safe place.

Please take the following steps to remove the bolts:

1. Loosen 4 bolts with spanner and then remove them.
2. Stop the holes with transport hole plugs.
3. Keep the transport bolts properly for future use.

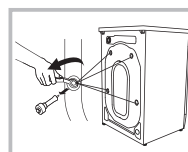

INSTALLATION

Levelling the washer dryer

⚠ Warning!

- The lock nuts on all four feet must be screwed tightly against the housing.

1. Check if the legs are closely attached to the cabinet. If not, please turn them to their original positions and tighten the nuts.
2. Loosen the lock nut turn the feet until it closely contacts with the floor.
3. Adjust the legs and lock them with a spanner, make sure the machine is steady.

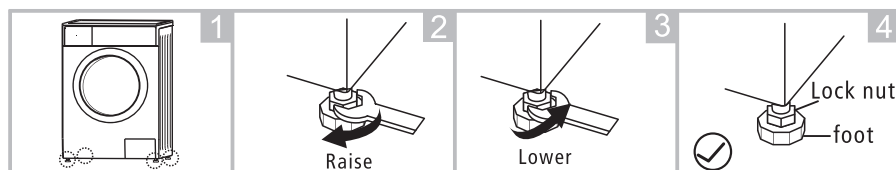

Connect Water Supply Hose

⚠ Warning!

- To prevent leakage or water damage, follow the instructions in this chapter!
- Do not kink, crush, modify or sever water inlet hose.
- For the model which equips with hot valve, connect it to hot water tap with hot water supply hose. Energy consumption will decrease automatically for some program.

Connect the inlet pipe as indicated, There are two ways to connect the inlet pipe.

1. Connection between ordinary tap and inlet hose.

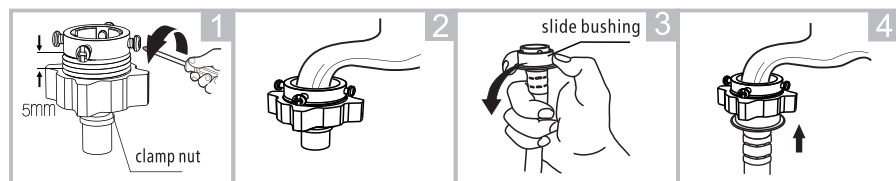

Loosen clamp nut and four bolts

Tighten clamp nut

Press slide bushing, insert inlet hose into connecting base

Connection finished

2. Connection between screw tap and inlet hose.

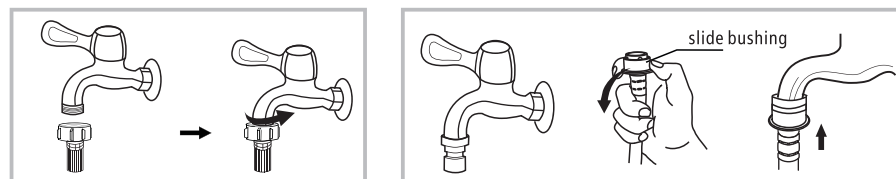

Tap with threads and inlet hose

Special tap for washer dryer

INSTALLATION

Connect the other end of inlet pipe to the inlet valve at the backside of product and fasten the pipe tightly clockwise.

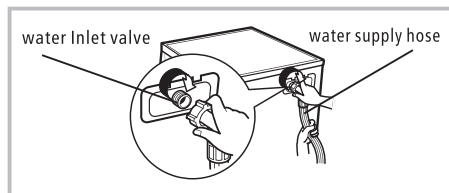

Drain Hose

⚠ Warning!

- Do not kink or protract the drain hose.
- Position drain hose properly ,otherwise damage might result in water leakage.

There are two ways to place the end of drain hose:

1.Put it into the water trough.

2.Connect it to the branch drain pipe of the trough.

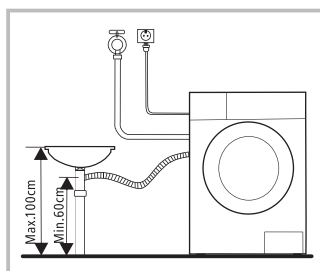
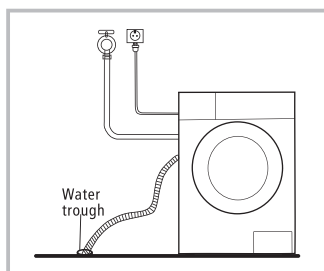

📌 Note!

- If the machine has drain hose support, please install it like the following .

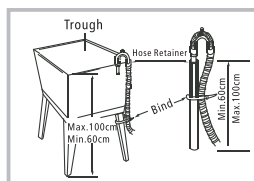
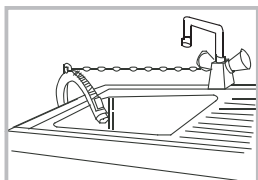

⚠ Warning!

- When installing drain hose, fix it properly with a rope.
- If drain hose is too long, do not force it into washing machine as it will cause abnormal noises.

OPERATIONS

■ Quick Start

⚠ Caution!

- Before washing, please make sure it's installed properly.
- Before washing for the first time, the washing machine shall be operated in a complete round of washing cycle without clothes in as follows.

1. Before Washing

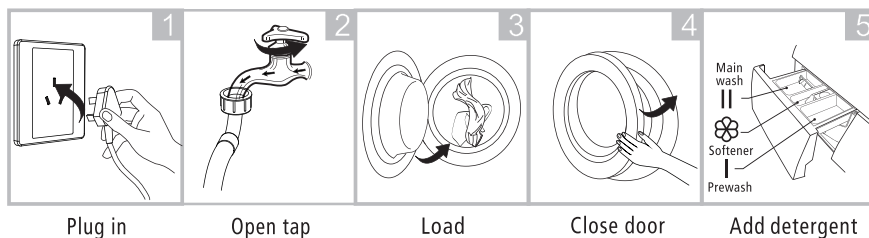

📌 Note!

- Detergent only need to be added in "case I "after selecting pre-washing for machines with the function.

2. Washing

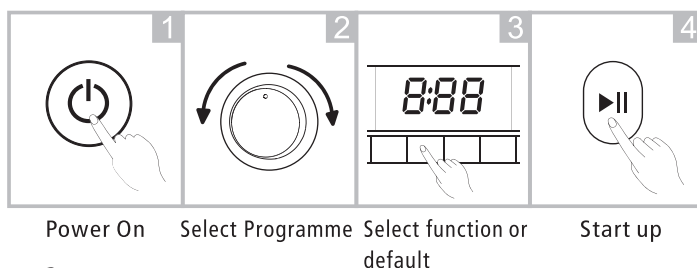

📌 Note!

- 1.If default is selected, step 3 can be skipped.
- 2.The function button line chart is for reference only, please refer to real product as standard.

3. After Washing

Buzzer beep or "End" on display.

OPERATIONS

■ Before Each Washing

- The working condition of the washer should be (0-40) °C. If used under 0 °C, the inlet valve and draining system may be damaged. If the machine is placed under condition of 0 °C or less, then it should be transferred to normal ambient temperature to ensure the water supply hose and drain hose are not frozen before use.
- Please check the labels and the explanation of using detergent before wash. Use non-foaming or less-foaming detergent suitable for machine washing properly.

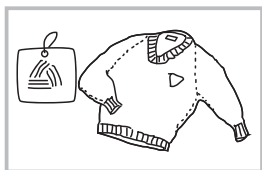

Check the label

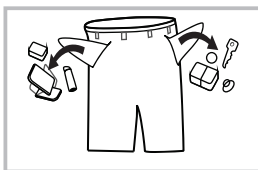

Take out the items out of the pockets

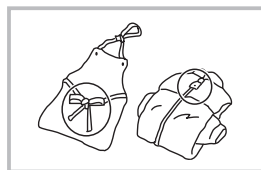

Knot the long strips, zip or button

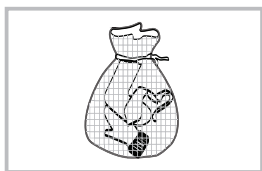

Put small clothes into the pillow slip

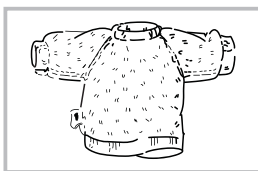

Turn easy-pilling and long-pile fabric inside out

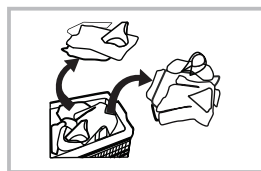

Separate clothes with different textures

⚠ Warning!

- When washing a single garment, it may easily cause great eccentricity and give alarm due to great unbalance. Therefore it is suggested to add one or two more clothes to be washed together so that draining can be done smoothly.
- Don't wash the clothes touching with kerosene, gasoline, alcohol and other flammable substances.

OPERATIONS

■ Detergent Drawer

- I Pre wash detergent
- II Main wash detergent
- ☼ Softener

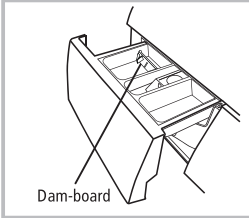

Liquid detergent

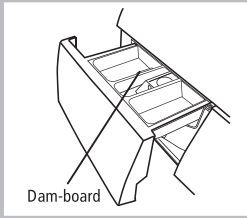

Powder detergent

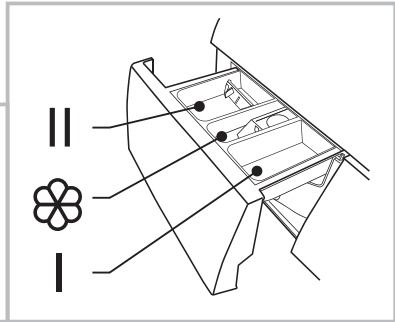

Pull out the drawer

⚠ Caution!

- Detergent only need to be added in "case I " after selecting pre-washing for machines with the function.

| Programme | I | II | ☼ | Programme | I | II | ☼ |
|---------------|---|----|---|------------|---|----|---|
| Automatic | | ● | ○ | Cotton | ○ | ● | ○ |
| Active Speed | ○ | ● | ○ | Cotton Eco | | ● | ○ |
| 1H Wash & Dry | | ● | ○ | Synthetic | ○ | ● | ○ |
| Soak | ○ | ● | ○ | Colors | | ● | ○ |
| Rinse+Spin | | | ○ | Delicates | | ● | ○ |
| Spin Only | | | | Baby-care | ○ | ● | ○ |
| Dry Only | | | | Bedding | | ● | ○ |
| Tub Clean | | ● | | Rapid 15 | | ● | ○ |

● Means must ○ Means optional

OPERATIONS

Note!

- As for the agglomerated or ropy detergent or additive, before they are poured into the detergent box, it is suggested to use some water for dilution to prevent the inlet of detergent box from being blocked and overflowing while filling water.
- Please choose suitable type of detergent for the various washing temperature to get the best washing performance with less water and energy consumption.

OPERATIONS

Control Panel

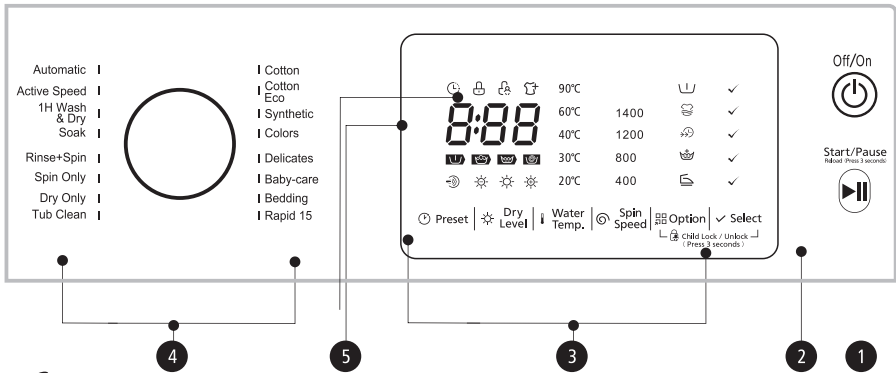

Note!

- The chart is for reference only, Please refer to real product as standard.
- The programme with can be choose Speed Wash function.

1 Off/On

Product is switched on or off.

2 Start/Pause

Press the button to start or pause the washing cycle.

3 Option

This allows you to select an additional function and will light when selected.

4 Programmes

Available according to the laundry type.

5 Display

The display shows the settings, estimated time remaining, options, and status messages for your washer. The display will remain on throughout the cycle.

| | |
|---|-------------------------|
| A Preset | G Option Confirm |
| B Door Lock | H Speed Wash |
| C Child Lock | I Extra Rinse |
| D Reload | J Anti-crease |
| E Pre Wash | K Spin Speed |
| F Extra Wash | L Water Temp. |
| M Rate Of Progress(Pre wash- Wash -Rinse-Spin) | |
| N Dry level(Air Dry-Gentle Dry-Normal Dry-Extra Dry) | |
| O Wash Time | Delay Time |
| 125 | 2h |
| Error | End |
| E20 | End |

OPERATIONS

■ Option



Pre Wash

The Prewash function can get an extra wash before main wash, it is suitable for washing the dust rises to surface of the clothes; You need to put detergent into the Case (I) when select it.



Extra Rinse

The laundry will undergo extra rinse once after you select it.



Speed Wash

The function can decrease the washing time.



Preset

Set the Preset function:

1. Select a programme
2. Press the Preset button to choose the time (the delaying time is 0-24 H.)
3. Press [Start/Pause] to commence the preset operation



Off/On



Choose the Programme



Setting time



Start

Cancel the Preset function:

Press the [Preset] button until the display be 0H. It should be pressed before starting the programme. If the programme already started, you should press the [Off/On] button to reset the programme.

⚠ Caution!

- If there is any break in the power supply while the machine is operating, a special memory stores the selected programme and when the power is restarted, press the [Off/On] button the program will continue.
-



Extra Wash

Suitable for filthy clothes. It can increase the washing time and intensity to enhance the washing effect.



Anti-crease

Anti-crease function can be used to reduce the wrinkles of clothes.

OPERATIONS

| Programme | Option | | | | | |
|---------------|--------|---------|------------|------------|-------------|-------------|
| | Preset | Prewash | Extra Wash | Speed Wash | Extra Rinse | Anti-crease |
| Cotton | ○ | ○ | ○ | ○ | ○ | ○ |
| Cotton Eco | ○ | | | | | |
| Synthetic | ○ | ○ | ○ | ○ | ○ | ○ |
| Colors | ○ | | | ○ | ○ | ○ |
| Delicates | ○ | | | | ○ | ○ |
| Baby-care | ○ | ○ | ○ | ○ | ○ | ○ |
| Bedding | ○ | | ○ | ○ | ○ | ○ |
| Rapid 15 | ○ | | | | | |
| Automatic | ○ | | | | | |
| Active Speed | ○ | ○ | ○ | ○ | ○ | ○ |
| 1H Wash & Dry | ○ | | | | | |
| Soak | ○ | ○ | ○ | ○ | ○ | ○ |
| Rinse+Spin | ○ | | | | ○ | ○ |
| Spin Only | ○ | | | | | ○ |
| Dry Only | ○ | | | | | |
| Tub Clean | ○ | | | | | |

○ Means optional

OPERATIONS

■ Other functions



Reload

This operation can be executed during the washing progress. When the drum is still rolling and there is large amount of water with high temperature in the drum. This state is unsafe and the door cannot be opened forcefully. Press [Start/Pause] for 3 sec. to reload, and start the clothes adding in the midway function. Please follow the steps as bellow:

- 1.Wait until the drum stops rotation.
- 2.The door lock is unlocked.
- 3.Close the door when the clothes are reloaded and press the [Start/Pause] button.



Press[Start/Pause]3sec.

Reload the clothes

Start

⚠ Caution!

- Don't use the Reload function when the water level over the edge of the inner tub or the temperature is higher.



Child Lock

To avoid misoperation by children.



Off/On

Start/Pause

Press [Option] and [Select]
3 sec. till buzzer beep.

⚠ Caution!

- Press the two button 3 sec. at the same time to activate the function.
- The "Child Lock" will lock all buttons except [Off/On].
- Cut off the power supply , the kid's protection is to be activated.
- The child lock will remain effective when the power is resumed for some models.

OPERATIONS

Water Temp.

Water Temp.
Press the button to regulate the temperature(Cold,20 °C,30 °C, 40 °C,60 °C,90 °C)

Spin Speed

Spin Speed
Press the button to change the spin speed.

| Programme | Default Speed(rpm) | Programme | Default Speed(rpm) |
|---------------|--------------------|------------|--------------------|
| Automatic | 800 | Cotton | 800 |
| Active Speed | 800 | Cotton Eco | 1200 |
| 1H Wash & Dry | 1400 | Synthetic | 800 |
| Soak | 800 | Colors | 1200 |
| Rinse+Spin | 1200 | Delicates | 800 |
| Spin Only | 1200 | Baby-care | 800 |
| Dry Only | 1400 | Bedding | 800 |
| Tub Clean | - | Rapid 15 | 800 |



Caution!

- When the light of speed indicator is off, it means the spin speed is 0.

OPERATIONS



Mute the buzzer

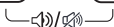

Off/On

Start/Pause

Press the [Dry Level] & [Water Temp.] button for 3 sec. the buzzer will mute.

To activate the buzzer function, press the two buttons again for 3 seconds. The setting will be kept until the next reset.



Caution!

- After Muting the buzzer function, the sounds will not be activated anymore.



Dry

Press the Dry button continuously to choose the dry level: Extra Dry/Normal Dry/Gentle Dry/Air Dry.

- ☀ Extra Dry: Suitable if you need to wear the clothes immediately
- ☀ Normal Dry: The normal dry procedure
- ☀ Gentle Dry: Slightly dry is fine.
- 🌀 Air Dry: Clothes is spinned to remove peculiar smell without water in high temperature.



Note!

- Drying hints
 - Clothes should be dried after spinning
 - To ensure the quality, please classify the laundry according to types and suitable drying temperature when drying the clothes.
 - Synthetic should be set the proper drying time .
 - If you want to iron the clothes after drying, please wait for a while.
- Clothes not suitable for drying
 - Particularly delicate items such as synthetic curtains, woolen and silk, clothes with metal inserts, nylon stockings, bulky clothes, such as anoraks, bedcovers, quilts, sleeping bags and duvets must not be dried.
 - Clothes padded with foam-rubber or materials similar to foam-rubber must not be machine dried.
 - Fabrics containing residues of setting lotions or hair sprays, nail solvents or similar solutions must not be machine dried in order to avoid the formation of harmful vapours.



Select Confirm

Confirm the selection of the Pre Wash, Extra Rinse, Extra Wash, Speed Wash or Anti-crease function.

OPERATIONS

■ Programmes

Programmes are available according to the laundry type.

| Programmes | |
|---------------|---|
| Cotton | Hard-wearing textiles, heat-resistant textiles made of cotton or linen. |
| Cotton Eco | To enhance the washing effects, washing time is increased. |
| Synthetic | Wash synthetic articles, for example: shirts, coats, blending. While washing the knitting textiles, detergent quantity shall be reduced due to its loose string construction and easily forming bubbles. |
| Colors | Washing brightly colored clothes, it helps protect the colors better . |
| Delicates | For delicate, washable textiles, e.g. made of silk, satin, synthetic fibres or blended fabrics. |
| Baby-care | Washing the baby's clothes, it makes the baby's wear cleaner. and make the rinse performance better to protect the baby skin. |
| Bedding | This program is specially designed for washing duvet coats. |
| Rapid 15 | This procedure is suitable for washing a few and not very dirty clothes quickly |
| Automatic | For the convenience of the users, this program can adjust the washing time according to the load. |
| Active Speed | When you start this function , it will increase more foam in the bucket . then it will improve the wash performance |
| 1H Wash & Dry | For small synthetic clothes or shirts, load limitation is 1 kg (about 4 shirts). When you have an urgent appointment but no more clean shirt left in your cupboard, this program will help you. Time duration is only 1 hour including wash and dry. Remark: Big towels or jeans is not suitable for this program, they will enlarge the time duration and affect the moisture content. |
| Soak | Soak the washing machine for a while before washing . |
| Rinse+Spin | Extra rinse with spin. |
| Spin Only | Extra spin with selectable spin speed. |
| Dry Only | Select it to dry clothes, the temperature is different . The drying time according to the load . |
| Tub Clean | This programme is specially set in this machine to clean the drum and tube. It applies 90 °C high temperature sterilization to wash the clothes in a cleaner way. When this procedure is performed, the clothes or other washing cannot be added. When proper amount of chlorine bleaching agent is put in, the barrel cleaning effect will be better. The customer can use this procedure regularly according to the need. |

Note!

- Refer to your product to select the suitable programmes.

OPERATIONS

■ Washing Programmes Table

| Programme | Washing/Drying Load (kg) <small>*Dry cloth</small> | | | Water Temp.(°C) | Default Time(H) | | |
|-----------------|--|----------|----------|-----------------|-----------------|------|------|
| | 8.0 | 10.1 | 12.0 | | 8.0 | 10.1 | 12.0 |
| | | | | Default | 1400 | 1400 | 1400 |
| Cotton Eco | 8.0 | 10.1 | 12.0 | 60 | 1:53 | 1:53 | 1:53 |
| Bedding | 4.0 | 5.0 | 6.0 | 30 | 1:20 | 1:20 | 1:20 |
| Tub Clean | — | — | — | 90 | 1:18 | 1:18 | 1:18 |
| Delicates | 2.5 | 2.5 | 2.5 | 30 | 0:50 | 0:50 | 0:50 |
| Automatic | 8.0 | 10.1 | 12.0 | 40 | — | — | — |
| Colors | 4.0 | 5.0 | 6.0 | Cold | 1:10 | 1:10 | 1:10 |
| Soak | 8.0 | 10.1 | 12.0 | 40 | 2:04 | 2:04 | 2:04 |
| Spin Only | 8.0 | 10.1 | 12.0 | — | 0:12 | 0:12 | 0:12 |
| Rinse+Spin | 8.0 | 10.1 | 12.0 | — | 0:20 | 0:20 | 0:20 |
| ☼ Dry Only | —/6.0 | —/7.0 | —/8.0 | — | 3:58 | 4:39 | 5:39 |
| Active Speed | 8.0 | 10.1 | 12.0 | 40 | 0:59 | 0:59 | 0:59 |
| ☼ Baby-care | 8.0/4.0 | 10.1/5.0 | 12.0/6.0 | 30 | 1:20 | 1:20 | 1:20 |
| ☼ Synthetic | 4.0/4.0 | 5.0/5.0 | 6.0/6.0 | 40 | 1:40 | 1:40 | 1:40 |
| ☼ Cotton | 8.0/6.0 | 10.1/7.0 | 12.0/8.0 | 40 | 2:40 | 2:40 | 2:40 |
| ☼ 1H Wash & Dry | 1.0/1.0 | 1.0/1.0 | 1.0/1.0 | Cold | 0:59 | 0:59 | 0:59 |
| Rapid 15 | 2.0 | 2.0 | 2.0 | Cold | 0:15 | 0:15 | 0:15 |

Note!

- The parameters in this table are only for user's reference. The actual parameters may be different from the parameters in above mentioned table.
- The programme with ☼ can be choose dry function.

MAINTENANCES

■ Cleaning And Care

⚠ Warning!

- Before your maintenance starts, please unplug the machine and close the tap.

Cleaning The Cabinet

Proper maintenance on the washing machine can extend its working life. The surface can be cleaned with diluted non-abrasive neutral detergents when necessary. If there is any water overflow, use a wet cloth to wipe it off immediately. No sharp item is allowed.

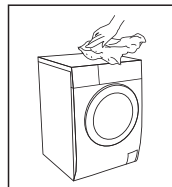

📌 Note!

- Formic acid and its diluted solvents or equivalent are forbidden, such as alcohol, solvents or chemical products, etc.

Cleaning The Drum

The rusts left inside the drum by the metal articles shall be removed immediately with chlorine-free detergents. Never use steel wool.

📌 Note!

- Don't put laundry in the washing machine during the drum cleaning.

Cleaning The Door Seal And Glass

Wipe the glass and seal after each wash to remove lint and stains. If lint builds up it can cause leaks. Remove any coins, buttons and other objects from the seal after each wash.

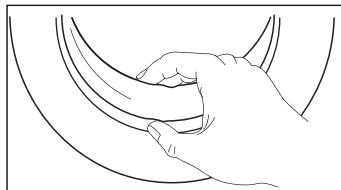

📌 Note!

- When washing machine is not in use, the door should be opened to ventilate the air of the drum.

MAINTENANCES

Cleaning The Inlet Filter

Note!

- Inlet filter must be cleaned if there is less water.

Washing the filter in the tap

1. Close the tap.
2. Remove the water supply hose from the tap.
3. Clean the filter.
4. Reconnect the water supply hose.

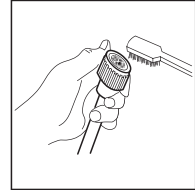
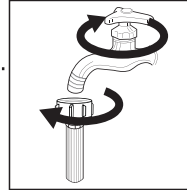

Washing the filter in washer dryer:

1. Screw off the inlet pipe from the backside of the machine.
2. Pull out the filter with long nose pliers and reinstall it back after being washed.
3. Use the brush to clean the filter.
4. Reconnect the inlet pipe.

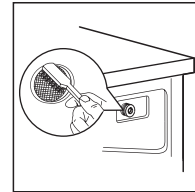
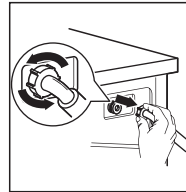

Note!

- If the brush is not clean, you can pull out the filter washed separately;
- After reconnecting the pipe, turn on the tap.

Clean Detergent Drawer

1. Press down the arrow location on softener cover inside the drawer.
2. Lift the clip up and take out softener cover and wash all grooves with water.
3. Restore the softener cover and push the drawer into position.

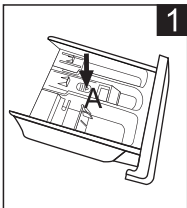

Pull out the drawer with press the A

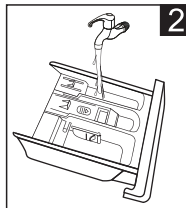

Clean the drawer under water

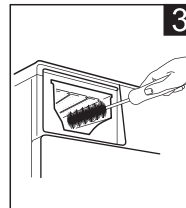

Clean inside the recess with an old toothbrush

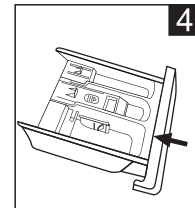

Insert the drawer

Note!

- Do not use alcohol, solvents or chemical products to clean the machine.

MAINTENANCES

Cleaning Drain Pump Filter

⚠ Warning!

- Be careful of hot water!
- Allow detergent solution to cool down.
- Unplug the machine to avoid electrical shock before washing.
- Drain pump filter can filter the yarns and small foreign matters from the washing.
- Clean the filter periodically to ensure the normal operation of washing machine.

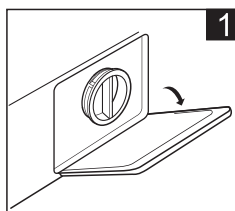

Open the lower cover cap

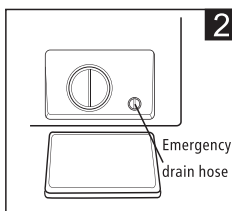

Rotate 90° and pull out the emergency drain hose, and take off the hose cap

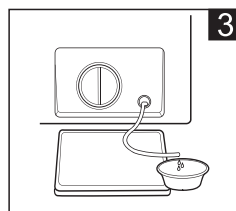

After water runs out, reset the drain hose

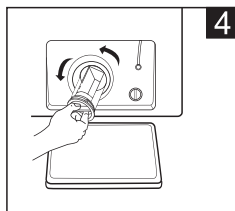

Open the filter in counter-clockwise direction

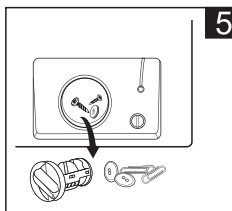

Remove extraneous matter

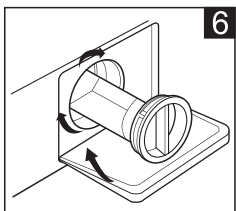

Close the lower cover cap

⚠ Caution!

- Make sure that valve cap and emergency drain hose are reinstalled properly, cap plates should be inserted aligning to hole plates otherwise water may leak;
- Some machines don't have emergency drain hose, so step 2 and step 3 can be skipped. Rotate lower cover cap directly to make water run into basin.
- When the appliance is in use and depending on the programme selected, there could be hot water in the pump. Never remove the pump cover during a wash cycle, always wait until the appliance has finished the cycle, and is empty. When replacing the cover, make sure that it is securely re-tightened.

MAINTENANCES

■ Trouble Shooting

The washer does not start, or it stops during operation.

Try to find the solution below. If the problem is not solved, please contact the service centre.

| Description | Reason | Solution |
|-------------------------------------|--|---|
| Washer dryer cannot start up | Door is not closed properly | Restart after the door is closed Check if the clothes is stuck |
| Door can't be opened | Washer's safety protection design is working | Disconnect the power, restart the machine |
| Water leakage | The connection between inlet pipe or outlet hose is not tight | Check and fasten water pipes Clean up outlet hose |
| Detergent residues in the box | Detergent is dampened or agglomerated | Clean and wipe the detergent box |
| Indicator or display does not light | Disconnect the power PC board or harness has connection problem | Check if the power is shut down and the power plug is connected correctly |
| Abnormal noise | | Check if the fixing (bolts) have been removed Check if it's installed on a solid and level floor |

| Description | Reason | Solution |
|-------------|---------------------------------------|---|
| E30 | Door is not closed properly | Restart after the door is closed Check if the clothes is stuck |
| E10 | Water injecting problem while washing | Check if the water pressure is too low Straighten the water pipe Check if the inlet valve filter is blocked |
| E21 | Overtime water draining | Check if the drain hose is blocked |
| E12 | Water overflow | Restart the washer |
| EXX | Others | Please try again first, Call the service centre if the problem still exists. |

Note!

- After checking, please restart the appliance. If a problem occurs or another error appears, please contact the service centre.
- When the washer is under drying mode, doors can only be opened after cooling down.

MAINTENANCES

■ Technical Specifications

Standard Water Pressure 0.05 MPa~1 MPa

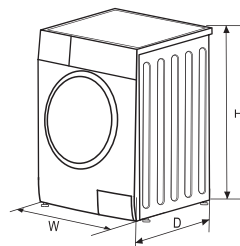

| Model | NA-S086F1 | NA-S107F2WBR | NA-S107F2WBZ |
|------------------|-------------------|---------------|---------------|
| Power Supply | 220-240 V~, 50 Hz | 220 V~, 60 Hz | 127 V~, 60 Hz |
| Washing Capacity | 8.0 kg | 10.1 kg | 10.1 kg |
| Drying Capacity | 6.0 kg | 7.0 kg | 7.0 kg |
| Dimension(WxDxH) | 595x470x850 | 595x565x850 | 595x565x850 |
| Weight | 64 kg | 71 kg | 71 kg |
| Rated Power | 1900 W | 1800 W | 1130 W |
| Drying Power | 1300 W | 1200 W | 1300 W |

| Model | NA-S128F2WBR | NA-S128F2WBZ |
|------------------|---------------|---------------|
| Power Supply | 220 V~, 60 Hz | 127 V~, 60 Hz |
| Washing Capacity | 12 kg | 12 kg |
| Drying Capacity | 8.0 kg | 8.0 kg |
| Dimension(WxDxH) | 595x595x850 | 595x595x850 |
| Weight | 73 kg | 73 kg |
| Rated Power | 1800 W | 1130 W |
| Drying Power | 1200 W | 1300 W |

MAINTENANCES

Note!

- Programme setting for testing in accordance with applicable standard EN 50229:2007+Commission Directive 96/60/EC.
- When using the test programmes, wash the specified load using the maximum spin speed.
- The actual parameters depend on how the appliance is used, and maybe different with the parameters in above mentioned table.
- The testing with Standard Programme(drying), the load is composed of two parts to test alone, the energy consumption, water consumption and programme duration are the total of the two parts.
- The household washer dryer machine is equipped with a power manager system. The duration of the left-on mode time is less than 1 minute.

Remarks:

- ① Estimated annual energy and water consumption for a four-person household, always using the dryer (based on 200 cycles) per year.
- ② Estimated annual energy and water consumption for a four-person household, never using the dryer (based on 200 cycles) per year;
Water consumption per year based on 220 standard washing cycles for standard programme at 60°C and 40°C at full and partial load. Actual water consumption depend on how the appliance is used.
- ③ The standard programme is the standard washing programme. The programme is suitable to clean normally soiled cotton laundry and they are the most efficient programmes in terms of combined energy and water consumptions for washing that type of cotton laundry. The actual water temperature may differ from the declared cycle temperature.
Please choose the suitable type of detergent for the various washing temperatures to get the best washing performance with less water and energy consumption.

MAINTENANCES

■ Installation Instruction of Rat Resistance Panel (Type A)

The rat resistance panel shall be installed before disassembling the transporting and the installation shall be done by at least two people.

First, tear off the paper on the surface of the foam tape.

Second, incline the washing machine in back direction to a suitable angle for purpose of installation. Please don't damage the machine surface when inclining the washing machine.

Third, insert the rat resistance panel by its intended direction requirement to the correct position:

side ④ shall be inserted on the cabinet rear flanging .

side ① and side ③ shall be positioned on the left and right bottom brackets.

Last, stick the side ② on the cabinet rear flanging with foam tape.

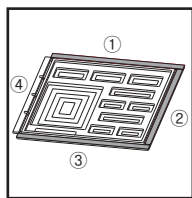
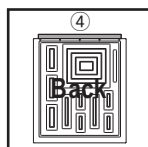
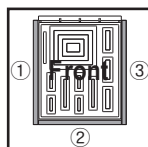

First step

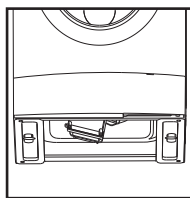

Second step

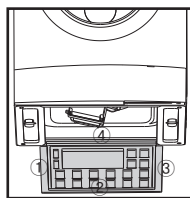

Third step

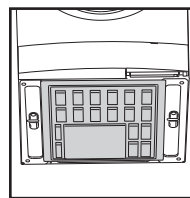

Last step

①～④ : The foam tape position

MAINTENANCES

Installation Instruction of Rat Resistance Panel (Type B)

Before disassembling the shipping bolt, the rat resistance panel should be installed.

Please follow the steps below to install the panel.

1. Incline the machine to a suitable angle for installation. Packaging pad can be used under the machine. When inclining the machine, make sure no damage is done to it.
2. Remove the tapes adhered to the four sides of panel.
3. Adjust the panel as per marked direction to the correct position, make sure the mark "F" leads to the front of the machine.
4. Stick the panel to the machine.

After all the steps above finished, please upright the machine to the correct position.

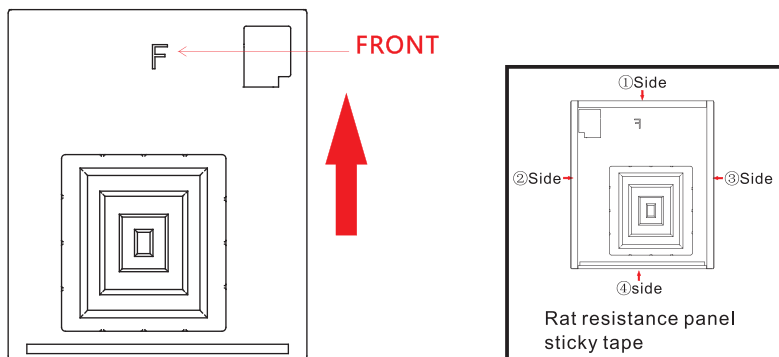

Arrow instruction of the inserting direction



First step

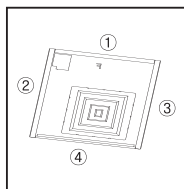

Second step

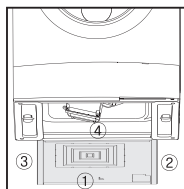

Third step

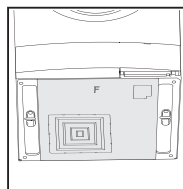

Last step

